

Fixed to electric travel trolley max 320 kg (perpendicular version)

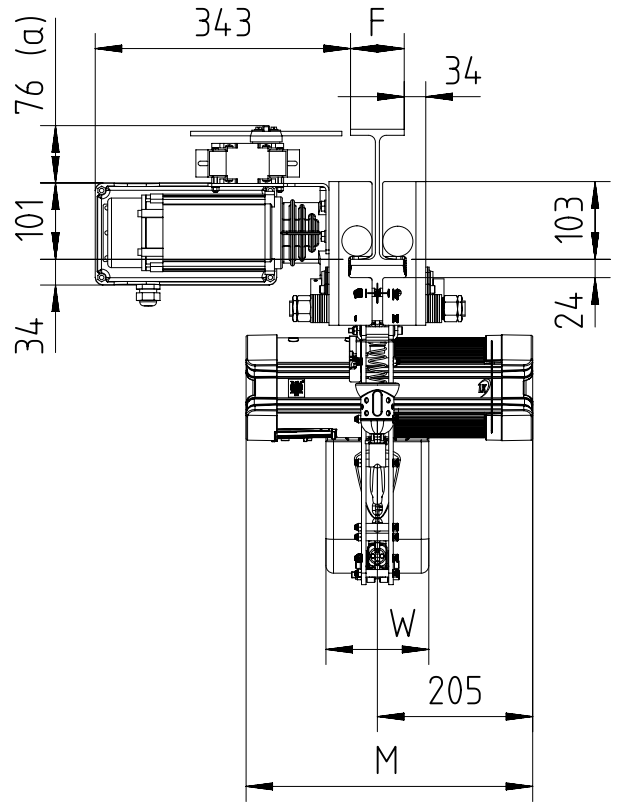
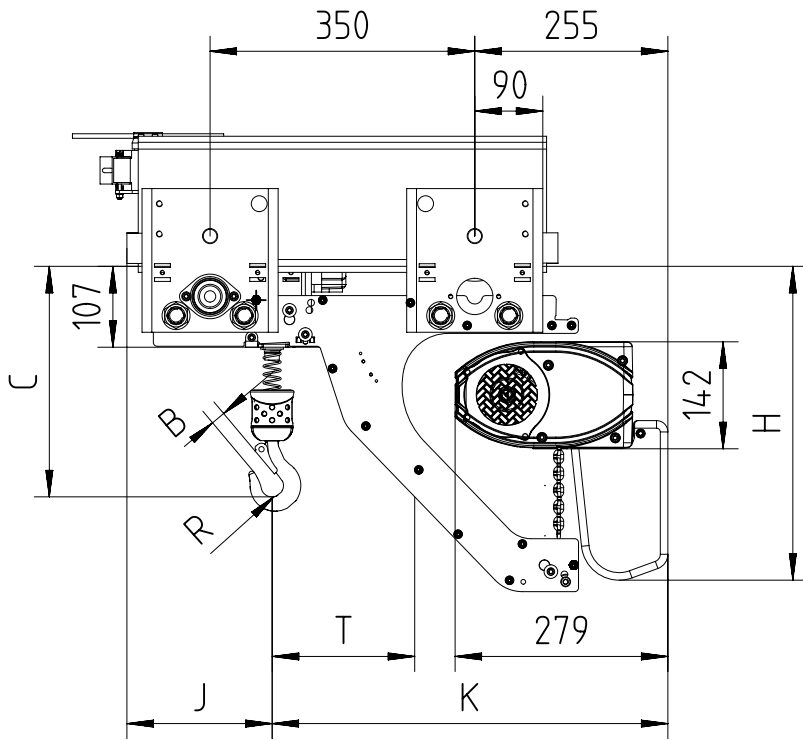

68 < F < 310

(a) Note: Trolley limit switch is optional.

Chain Size (mm)	Max load (kg)	Falls	Chain bag capacity (m)	Dimensions (mm)										Weight of chain (kg/m)	Estimated weight of hoist incl. trolley w/o chain (kg)		
				B	C	T	R	J	K	H	W	M			LK	GLS	DB
														LK	DB/GLS		
4X11	320	1	6	19	305	189	15	192	523	415	136	379	496	0.37	51	57	55
			16							515							
			35							665							

GLS: Gear Limit Switch
DB : Double Brake