

This document is the absolute property of R&M Materials Handling, Inc. This document must not be copied without the written permission of R&M Materials Handling, Inc. The contents thereof must not be disclosed to a third party nor be used for any unauthorized purpose. Contention will be prosecuted.

RTN50B END TRUCK

TOP JOINT PLATE TYPE J

Minimum Inner Wheel Distance (S)=1400 mm for wheel change
 M = S - 540 mm
 Mmin = 860 mm for wheel change
 Mmax = 5000 mm

Approx. Wgt (kg) = Weight/trk * 2 + 106 kg + 123 kg/m * (S - 0.9m)
 Approx. Wgt (lbs) = Weight/trk * 2 + 234 lbs + 83 lbs/ft * (S - 3 ft)
 Weight/trk is calculated with buffer type B.

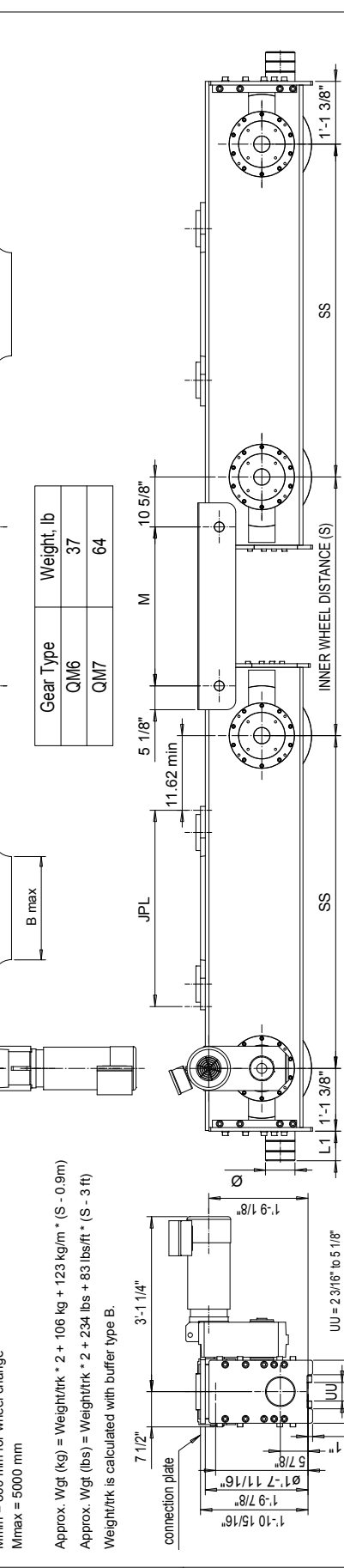

The wheel loads listed are only a guideline. The max. dyn. wheel load listed is based on the structural integrity of the frame and load placement, and it does not take into account permissible wheel loading or bearing life. The load placement is at the center of each truck. The permissible dynamic wheel load listed is based on assumptions that the bridge speed is 32 m/min (100 fpm), end truck duty is ISO M5 (FEM 2m), and the runway rail as listed. The actual wheel load should not exceed the permissible wheel load. If the permissible dynamic wheel load is greater than the maximum dyn wheel load, then the actual wheel load cannot exceed maximum dyn wheel load.

Dyn wheel load = 1.15 x static wheel load.

N=standard, E=Special
 -primer paint, color code
 Inner wheel distance (S), 1400 mm min.
 Buffer type
 Joint plate distance (pin to pin, with double DG girder)

Joint plate code
 S = 1WD, D = 2WD (Number of driving wheels)
 Wheel groove = JU
 Wheel base = SS
 B = Bogle
 End truck model

Product Code example
RTN50B1899SJ2207H1400-N

Wheelbase code	SS	Max dyn whl load, (kip)	Perm dyn whl load, (kip)	Approx. Wt.*/Trk (lb)
16	5'-3"	ASCE85	BETH 135	BETH 171
18	5'-10 7/8"	117	85.7	110
20	6'-6 3/4"	117	85.7	110
22	7'-2 5/8"	117	85.7	110
25	8'-2 7/16"	117	85.7	110

Joint plate	JPL	B max	Weight/pc (lb)
J1	37.00"	19.29"	183
J2	46.85"	29.33"	236
J3	60.63"	41.14"	300
J4	40.94"	19.29"	223
J5	49.61"	29.33"	227
J6	64.57"	41.14"	342
J7	41.73"	24.0"	212
J8	45.67"	24.0"	247
J9	51.57"	33.86"	267
J0	55.51"	33.86"	298

Buffer type	L1	Ø	Wgt/pc, lbs
B	2 11/16"	3 3/16"	1.8
C	3 5/16"	3 15/16"	3.1
D	4 1/8"	4 15/16"	5.5
E	5 15/16"	3 15/16"	2.2
F	7 1/2"	4 15/16"	3.6
H	6 5/16"	6 5/16"	5.5
I	7 7/8"	7 7/8"	9.7
M	4 15/16"	4 15/16"	2
P	9 7/16"	6 5/16"	6.9
S	11 13/16"	7 7/8"	12.4
T	13 3/4"	9 7/8"	16.8
Y	18 3/4"	9 7/8"	23

B, C, D rubber
 K, G, E, F, H, I, M, P, S polyurethane

Design	Chd	Appd	Ref Drawing
2008-08-11			
SLEDDOCV			END TRUCK
Part			OUTLINE DRAWING
Order			RTN50B-J
ECN608			RTN50B END TRUCK TOP JOINT
Issue			3/2017

R&M MATERIALS HANDLING, INC.
 1001 SHERWOOD DRIVE
 SPRINGFIELD, OH 45502