

This document is the absolute property of R&M Materials Handling, Inc. This document must not be copied without the written permission of R&M Materials Handling, Inc. The contents thereof must not be disclosed to a third party nor used for any unauthorized purpose. Contention will be prosecuted.

RU20 UNDER RUNNING END TRUCK

Wheelbase, SS (mm)	Max Dyn. Corner Load (kN)	L (mm)	Approx. Wt. (kg)	H (mm)
1800	143.8	2480	717	300
2300	143.8	2980	776	300
2800	143.8	3480	834	300
3200	143.8	3880	980	360
3500	143.8	4180	1016	360
4200	143.8	4680	1087	360

Dyn Load = 1.15 * Static Load

Buffer type	L1 (mm)	D1 (mm)
A	53	63
B	68	80
C	85	100
D	105	125
E	150	100
F	190	125
G	100	100
K	80	80
M	125	125
A, B, C, D rubber E, F, G, K, M polyurethane		

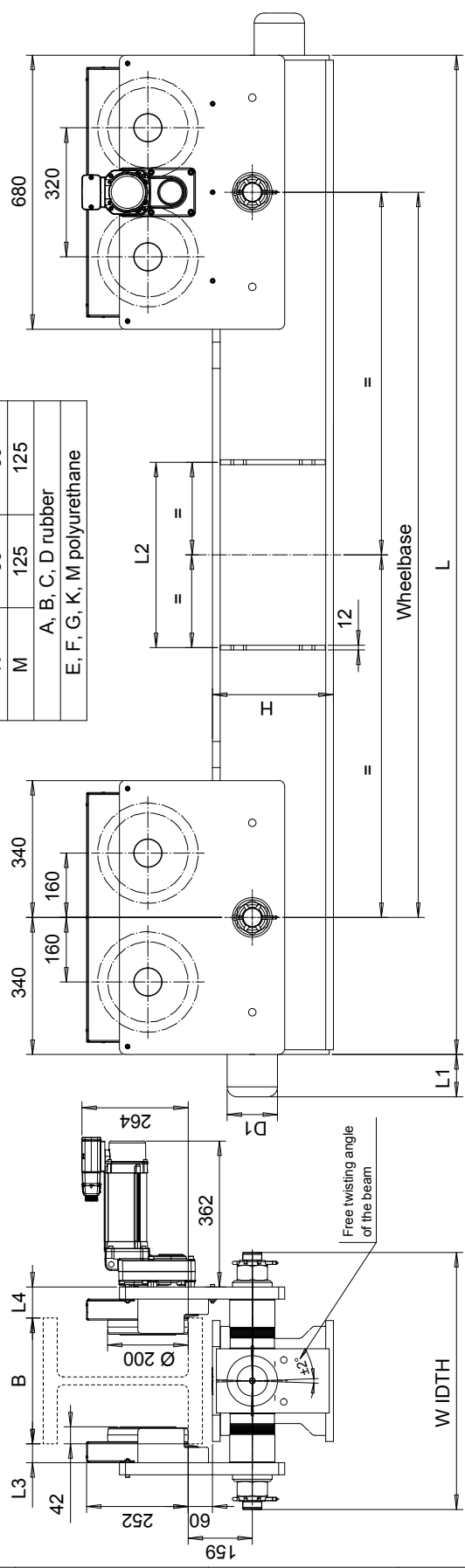

Location of stiffeners	L2 (mm)
Joint Plate	460
No Joint Plate	460
SD3, BD3, BD4	560
SD4, BD5	660

Flange width range, B (mm)	L3 (mm)	L4 (mm)	WIDTH (mm)
127 - 210	46	76	534
211 - 314	46	76	638
315 - 418	46	76	742
No patented track option			

Pos	Description	Specification	Id	Drawing
ETTPA Design	ETTPA Chd	ETTPA Chd		Ref Drawing
2008-08-11	END TRUCK	END TRUCK		
SLEDDOCV	OUTLINE DRAWING	OUTLINE DRAWING		
1-7	RU20	RU20		
Footer	RU20 END TRUCK	RU20 END TRUCK		
1-7	R&M MATERIALS HANDLING, INC.	R&M MATERIALS HANDLING, INC.		
UU20	SPRINGS	SPRINGS		
4/2012				