

R&M SPACEMASTER EX

DOUBLE GIRDER, 6 PART SINGLE
SX6 EX 061...D0

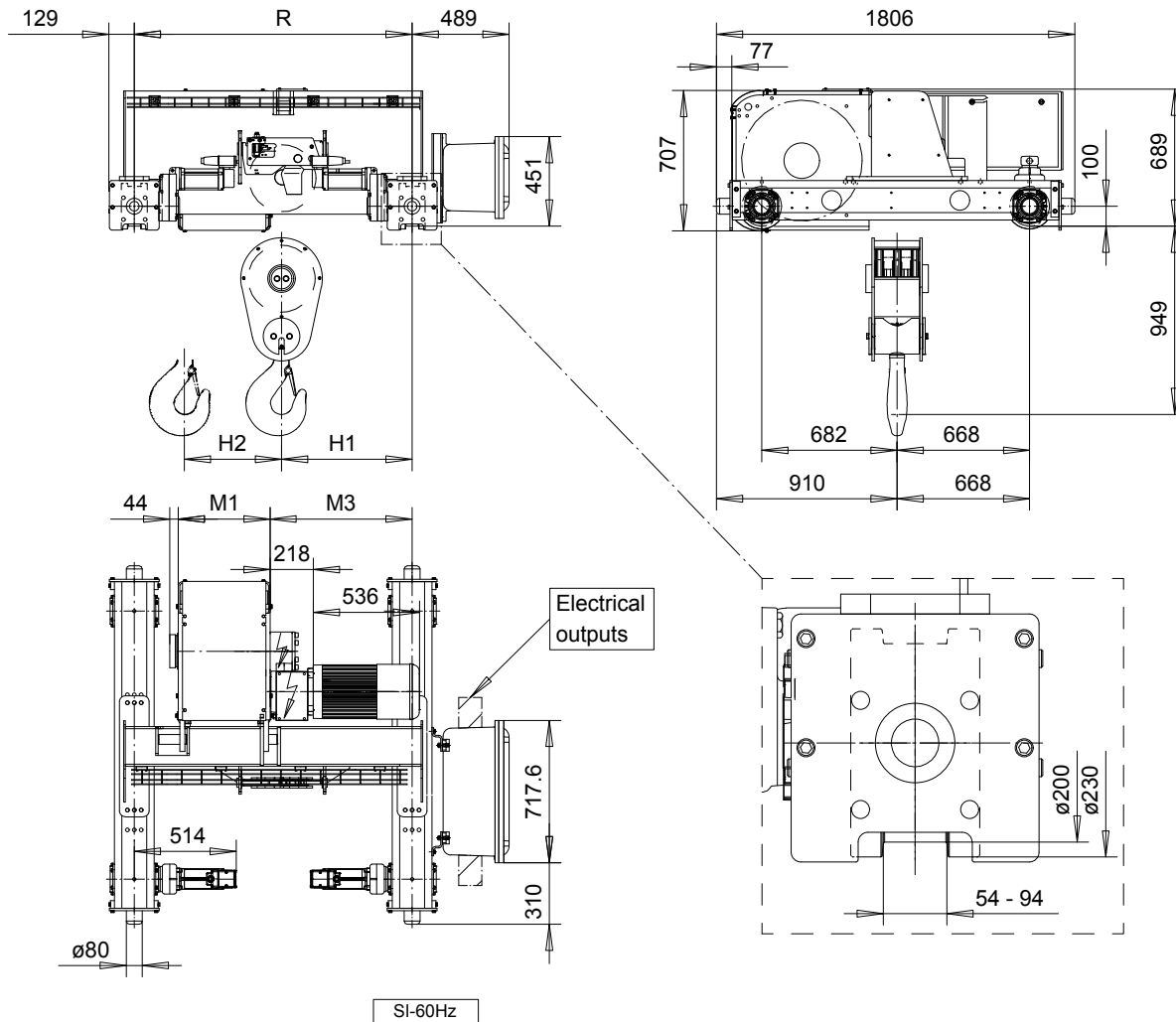

Load (kg)	Class	Hoisting speed (m/min)	
20000	Fem/ISO	3/0.5	3.8/0.6
	3m/M6		

HOL (m)	Length code	M1 (mm)	M3 (mm)	H1 (mm)	H2 (mm)	min R-max R (mm)	Weight (kg)
5	C	462	716	658	46	1400	1620
7	D	562	801	743	63	1700	1700
9	E	682	801	743	84	1700-2000	1750
12	F	832	951	893	107	2000-2700	1850
15.5	G	1022	1151	1093	140	2400-3100	1990
20	H	1272	1471	1413	182	3100-3800	2260
26.5	J	1622	1561	1503	240	3400-4200	2480
32	K	1922	1946	1888	289	4200	2860

min R is minimum rail gauge when service platform is supplied. Weight calculated at minR. Weight increases with longer gauges. Standard rail gauges are 1400, 1700, 2000, 2400, 2700, 3100, 3800, and 4200

R&M reserves the right to alter or amend the above information without notice