

Hoist type:

SXL18 052...R2400

SXL18 062...R2400

SXL18 082...R2400

SI units

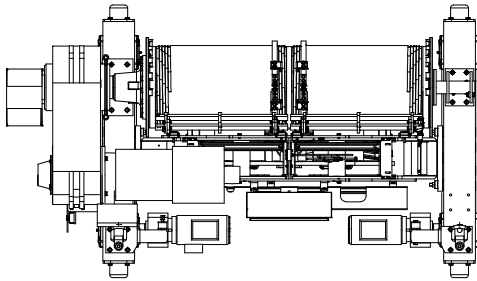
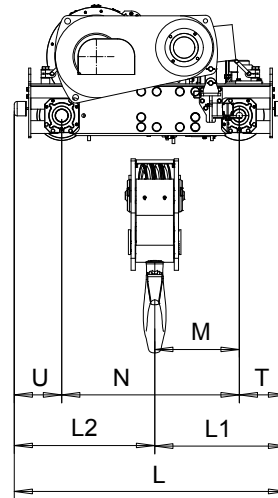
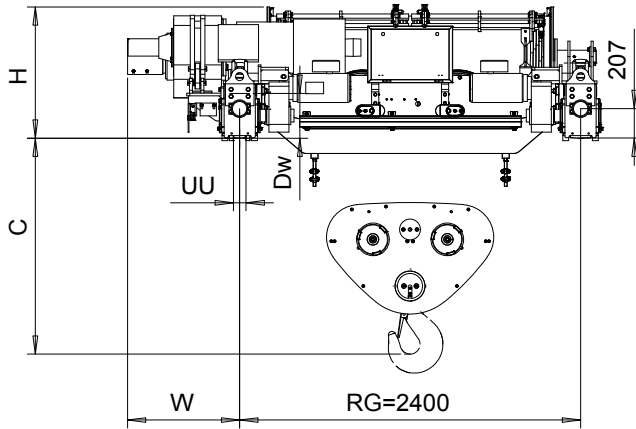

Hoisting trolley type	Duties 03...06	Hoisting trolley dimensions (mm)									Rail wheel (mm)		C (mm)		Weight (Kg)	
		H	M	N	L	L1	L2	T	U	W	Dw	UU*	RG24	RG24		
SXL18052	X	923	595	1250	1917	929	989	334	334	790	315	106	1520	5350		
SXL18062	X	923	575	1250	1917	909	1009	334	334	790	315	106	1520	5390		
SXL18082	X	923	540	1250	1917	874	1044	334	334	790	315	106	1586	5760		

Weight of the service platform is not included into trolley weight. * UU based on 100 mm rail.

This document is the absolute property of R&M Materials Handling, Inc. This document must not be copied without the written permission of R&M Materials Handling, Inc. The contents thereof must not be disclosed to a third party nor be used for any unauthorized purpose. Contravention will be prosecuted.

DESIGNER Design 2011-06-17 Date	Chd	Appd	Ref Drawing	
Owner Dept R&M MATERIALS HANDLING INC.	TROLLEY; DOUBLE GIRDER SXL18			1:25
R&M MATERIALS HANDLING, INC. HOIST & CRANE PRODUCTS SPRINGFIELD, OHIO	SXL18-R2400-052/062/082			Folder
	DA002713			Issue 3