

OLI is a secure, cloud-based interface designed to streamline maintenance and performance tracking for R&M rope hoists. Built for reliability and ease of use, OLI provides real-time access to equipment diagnostics, event history and usage insights; helping reduce downtime and optimize fleet performance. With its intuitive design and encrypted data transmission, the OLI app offers peace of mind while empowering smarter hoist management across your facility.

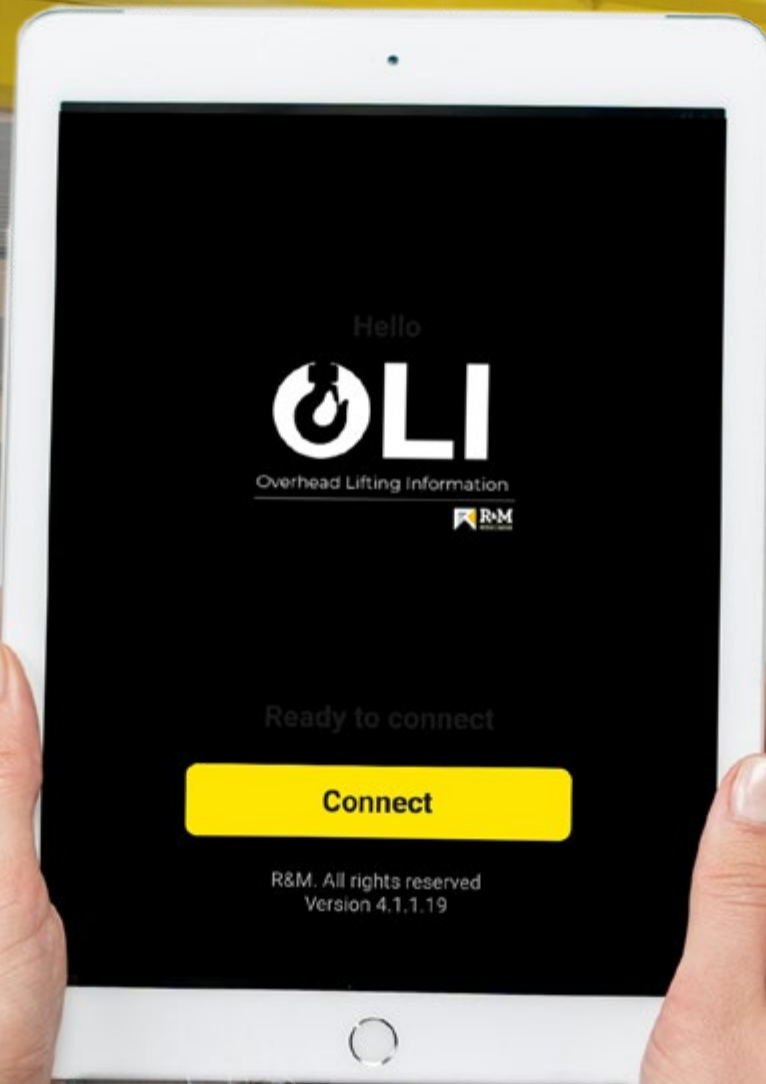

RISE ABOVE™



WHO IS OLI?

Your crane is one of your facility’s most valuable assets - OLI is here to protect it. Developed by R&M Materials Handling, OLI (Overhead Lifting Information) is a wireless-enabled app that connects to the HoistMonitor® or HoistMonitor® Enclave to deliver real-time hoist data directly to your iOS or Android device.

With OLI, you gain instant access to key condition, usage and event data - presented in a clear, easy-to-use format. Whether you’re monitoring maintenance needs, safety risks or operator training opportunities, OLI acts as your digital technician - always ready to keep operations running smoothly.

The system works through a Bluetooth key or gateway device installed in the hoist's electrical panel, which transmit data wirelessly. No need to access the crane - OLI brings the hoist's performance directly to your hands.

FAULTS

A fault means that the HoistMonitor or HoistMonitor Enclave has detected a situation that prevents the hoist from running in order to maintain the safety of the equipment and its operators. OLI displays faults in the events log, along with a description of the fault. Some examples of faults are overloads, the hoist brake not opening, the hoist motor being over the allowed temperature and electrical faults related to the hoist’s electrical components. Depending on the detected situation, hoisting, lowering or hoisting and lowering is totally prevented.

SERVICE WARNINGS

A service warning means that at least one calculated condition monitoring value has exceeded the corresponding design value. OLI will display a service warning in the conditions screen. Service warnings do not prevent operation of the equipment but do help to predict potentially needed maintenance. Service warnings can help predict when wearable items, like brakes and contactors, need replaced.

SUDDEN LOADING SUPERVISION

The HoistMonitor Enclave is programmed to force lifting into slow speed if it detects a sudden load condition. Sudden load conditions could occur if the bottom block or the load snags or catches on a fixed object during lifting, causing a potentially unsafe situation. This could also cause an overload, which would appear as a fault on your OLI app.

STARTS, STOPS & RUNTIME

Indicators such as the run time value, number of starts and stops, emergency stops and duty cycle calculation can help you understand how your equipment is being used. This data is invaluable for making informed decisions on frequency of inspections, operator training and product modernizations/purchases.

LOADS & OVERLOADS

Load information includes the amount of weight the hoist is picking up, the average weight the hoist has seen over its lifetime and the maximum weight the hoist has recorded. Overloading means that the operator attempted to lift an object that weighed more than the rated capacity of the hoist. OLI will reflect the number of overloads the hoist has recorded.

DESIGNED WORKING PERIOD

The Designed Working Period (DWP) indicates the period in which the equipment can be safely operated, provided the equipment has been used and maintained in line with the original expectations. OLI uses real data gathered by the HoistMonitor Enclave to display an easy-to-understand calculation of the remaining DWP. Facility managers can utilize this to more easily predict and schedule maintenance.



HOW DOES IT WORK?

R&M's OLI digital ecosystem is a comprehensive suite of hardware and software solutions designed to enhance crane monitoring, maintenance and operational efficiency. Each component in the ecosystem works in tandem with the other components, allowing the system to be customized with increasing levels of software functionality and operator assist features. This modular approach allows for scalability, based on the current and future needs of the application. The OLI app works together with the HoistMonitor Enclave device to bring you real-time information about how your equipment is performing. The gateway modem connects to the HoistMonitor device and wirelessly transmits the data to your mobile phone or tablet through the OLI app. The OLI app is compatible with both iOS and Android operating systems.

CONDITION

Use the condition tool to predict needed maintenance, plan downtime and reduce service costs. The DWP is displayed for the overall hoist as well as common wear items, such as contactors and brakes.

EVENTS

The events screen displays the faults recorded by the HoistMonitor Enclave.

This helps warn the crane operator of any problems and assists service technicians in troubleshooting issues which may affect hoist performance.

USAGE

On the usage screen, you will find information on current hoisting conditions, such as the control panel temperature and the current load being lifted. Important safety statistics, such as the number of emergency stops, is also displayed.

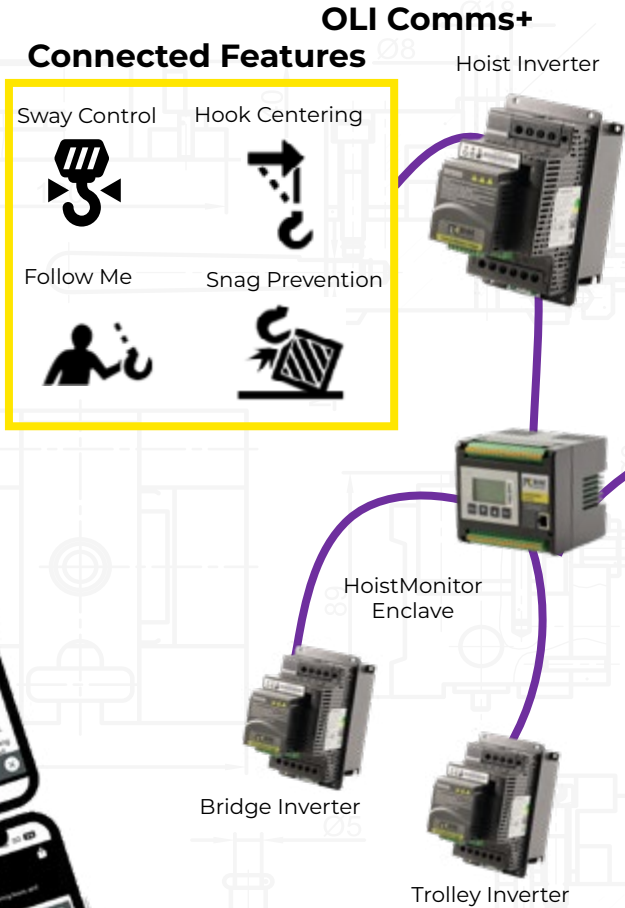





Which OLI is Right for You?

OLI App	Free app available on iOS and Google Play stores. App is able to be used with HoistMonitor or HoistMonitor Enclave devices, when the devices are equipped with the appropriate hardware.
OLI Comms	Combination of the HoistMonitor Enclave and gateway modem devices provided with the equipment, which facilitates the usage of all OLI digital services, including OLI App+ and OLI Pro.
OLI Comms+	Uses a communication protocol to gather data from HoistMonitor Enclave and ControlMaster® inverters on the crane. This creates an ecosystem of information that improves your ability to predict maintenance needs and indicate areas for performance improvement. OLI Comms+ facilitates the usage of all OLI digital services and enables usage of connected features.
OLI App+	Additional subscription within the OLI App, which allows technicians to edit parameters via the mobile app while connected to the HoistMonitor Enclave device via or HoistMonitor device via Bluetooth.
OLI Pro	Additional subscription within the OLI App, which allows service companies to remotely gather and view HoistMonitor Enclave data off site through cloud services.

Features with a lock are operated by crane service companies only. Contact your local R&M distributor to request a remote monitoring and enhanced services plan.



DOWNLOAD THE APP!



RISE ABOVE WITH R&M MATERIALS HANDLING, INC.

R&M has been innovating since 1929. With our heritage of innovation, our wire rope and chain hoist products have consistently set the crane industry norms. Our cutting-edge solutions will help you to rise above your material handling challenges. You deserve the best performance possible; let us help you achieve it!

R&M Materials Handling, Inc. may alter or amend the technical specifications identified herein at any time with or without notice.
R&M Materials Handling, Inc. is a proud member of the following organizations:

