

FOOT MOUNT, 4 PART SINGLE

Hoist type:

SX6 041...F0

US-60Hz

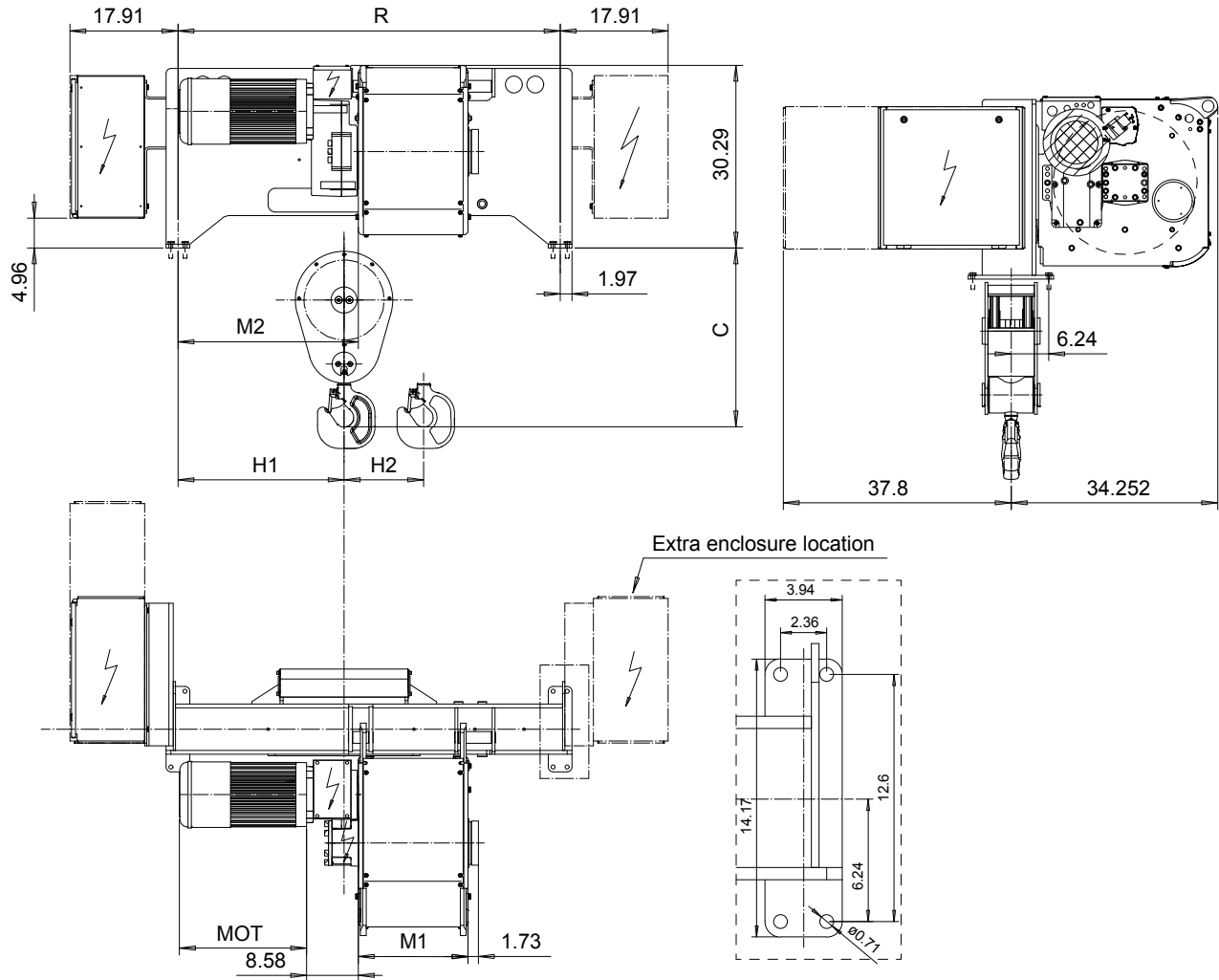

HOL (ft)	HOL* (ft)	Length code	R (inch)	M1 (inch)	M2 (inch)	H1 (inch)	H2 (inch)	Approx Weight (lb)
24'-6"	14'-9"	C	63.38	18.19	29.92	27.56	2.72	2866
34'-5"	24'-7"	D	63.38	22.13	29.92	27.56	3.7	2866
45'-11"	36'-1"	E	72.44	26.85	23.23	20.59	4.92	3086
59'-0"	49'-2"	F	72.44	32.75	23.23	20.59	6.34	3086
77'-1"	67'-3"	G	92.52	40.23	26.38	28.74	8.27	3527
100'-0"	90'-2"	H	92.52	50.07	26.38	28.74	10.75	3748
131'-2"	121'-4"	J	108.62	63.85	33.07	27.16	14.17	4189
159'-1"	149'-3"	K	108.62	75.66	33.07	27.16	17.09	4630

HOL* with optional drum brake Weight of drum brake is 176 lb.

Motor	P6	P7	P8	A7	S7	S8	SA
MOT (in)	21.1	22.7	28	21.1	28.1	30	31.6
Weight (lb)	187	231	234	157	179	214	265

Load (TON)	Class ASME
12 1/2	H4+
15	H4
20	H3

Headroom - C dimension	
Standard	29.7"
with HS22 Hook operated limit switch	31.7"

Hoist weight calculated with P6 motor weight and without drum brake.

This document is the absolute property of R&M Materials Handling, Inc. This document must not be copied without the written permission of R&M Materials Handling, Inc. The contents thereof must not be disclosed to a third party nor be used for any unauthorized purpose. Contravention will be prosecuted.

ETTPAL Design	ETTPAL Cnd	Appd	Ref Drawing	QD-F-04
2002-09-02 Date	HOIST; FIXED			
SLEODOCV Owner Dept	4 ROPE FALLS			
R&M MATERIALS HANDLING INC.	R&M MATERIALS HANDLING INC. HOIST & CRANE PRODUCTS SPRINGFIELD, OHIO			
D006937-A				Issue 11/2013