

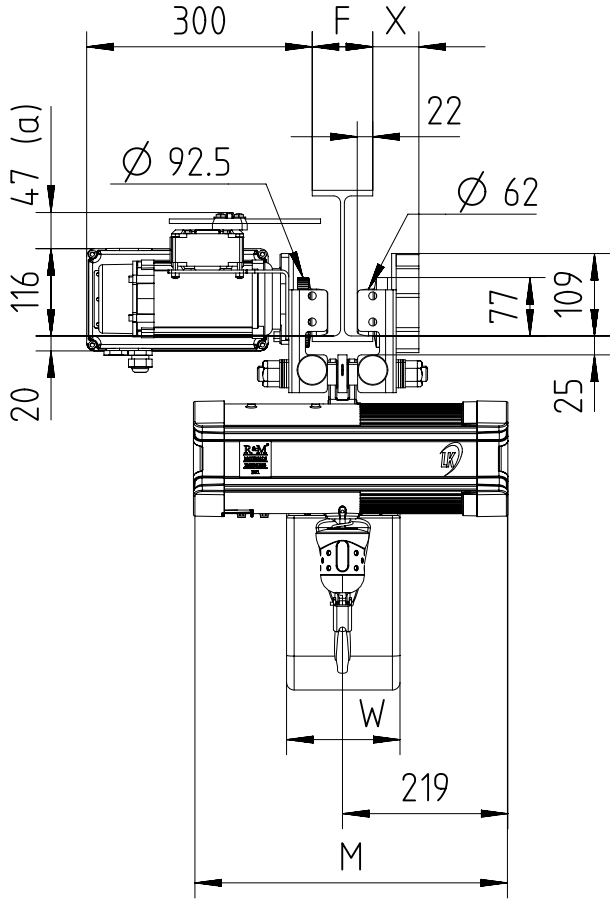

Fixed to electric travel trolley C1 max 630 kg (perpendicular version)

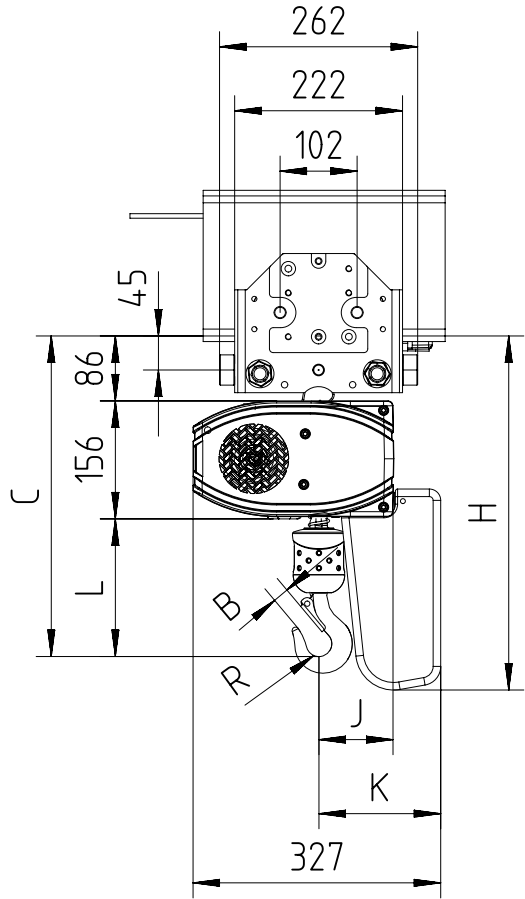

BEAM WIDTH	X
55 < F < 62	59
63 < F < 310	29

(a) Note: Trolley limit switch is optional.
 Note: Add 3 Kg for the trolley counter weight with the beam width range 55-62 mm.
 Note: Mini. radius of curve for C1 trolley is 2m.

Chain Size (mm)	Max load (kg)	Falls	Chain bag capacity (m)	Dimensions (mm)										Weight of chain (kg/m)	Estimated weight of hoist incl. trolley w/o chain (kg)			
				B	C	L	R	J	K	H	W	M			LK	LK Inverter	GLS	DB
												LK	LK Inverter/DB/GLS					
5X14	630	1	6	21	424	182	17	100	161	468	150	416	548	0.57	50	59	54	56
			16							533								
			25							656								

GLS: Gear Limit Switch
 DB: Double Brake

R&M reserves the right to alter or amend the above information without notice.

DISCLOSED WITHOUT PRIOR WRITTEN CONSENT OF THE COMPANY. ANY COPIES OF THIS DOCUMENT MADE BY ANY METHOD MUST ALSO INCLUDE A COPY OF THIS LEGEND.