

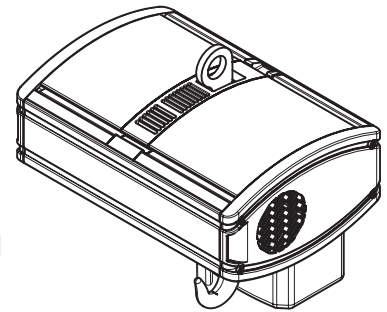

Eye suspended - 1 Fall (perpendicular version)

MAX 500 Kg

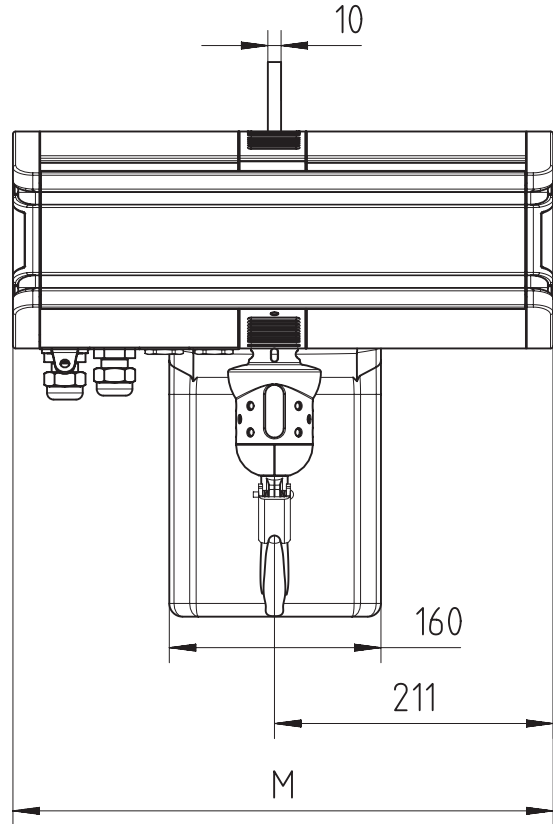
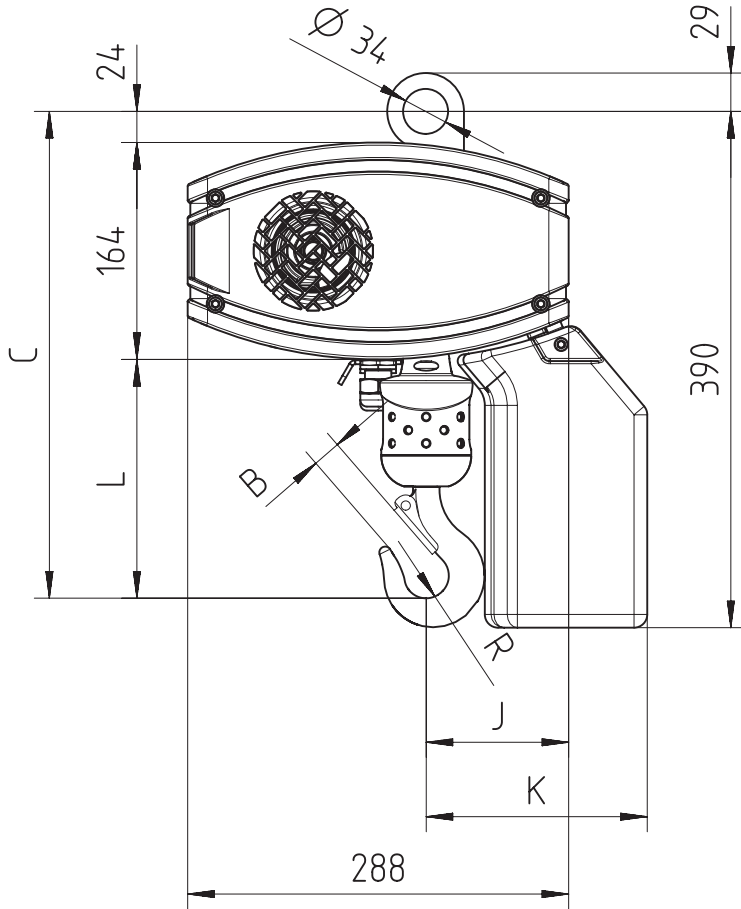

Note: For hoisting speed 16 m/min or higher, maximum load 250 Kg and chain size is 4x11, add 63 mm to dimension C and L.

Chain Size	Max load Kg	Chain bag capacity m	Dimensions in mm						Weight per meter Kg/m	Estimated unit weight w/o chain Kg			
			B	C	L	R	J	K		LK	LK Inverter	GLS	DB
5x14	500	8	21	368	180	17	107	167	0.57	29.7	33.6	31.9	30.7
4x11	250	12	19	344	156	15	109	169	0.37				
Dimension M in mm										408	531	498	438

GLS: Gear Limit Switch  
DB : Double Brake

R&M reserves the right to alter or amend the above information without notice.

DISCLOSED WITHOUT PRIOR WRITTEN CONSENT OF THE COMPANY . ANY COPIES OF THIS DOCUMENT MADE BY ANY METHOD MUST ALSO INCLUDE A COPY OF THIS LEGEND.

53093172  
D178088-A  
23/09/2013