

Fixed to hand chain trolley C3 max 3200 Kg (perpendicular version)

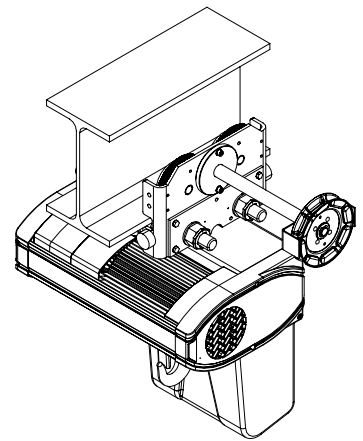
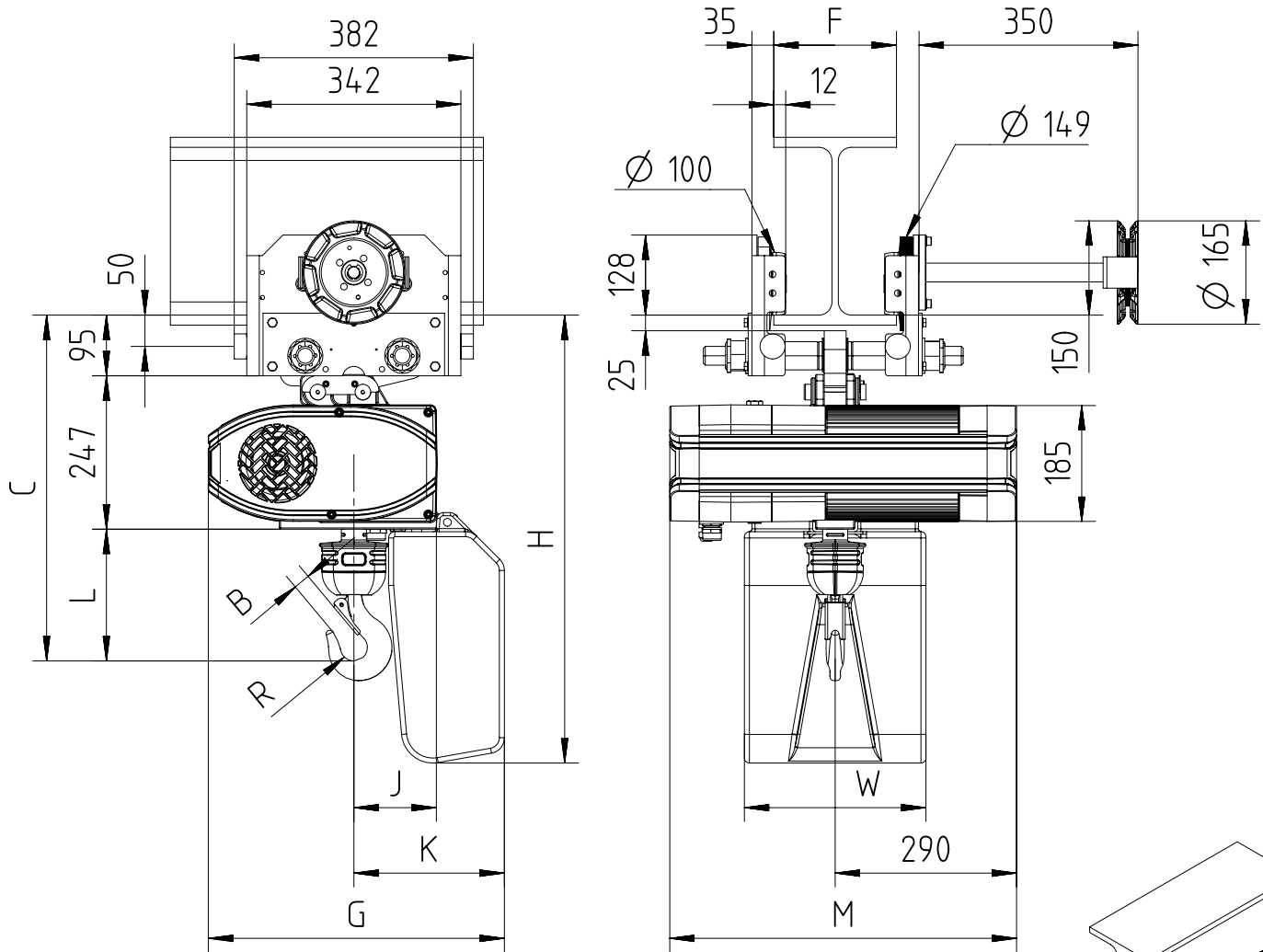

$82 < F < 310$

Note: In case of 2-fall hoist, coupling suspension is rotated by 180°.  
 Note: Mini. radius of curve for trolley 3200 Kg is 2m.  
 Note: Add 60mm to C & L dimension for hoisting speeds greater than 8 m/min.

| Chain Size (mm) | Max load (Kg) | Falls | Chain bag capacity (m) | Dimensions (mm) |     |     |    |     |     |     |     |     |     | Weight of chain (kg/m) | Estimated weight of hoist incl. trolley w/o chain (Kg) |     |     |     |
|-----------------|---------------|-------|------------------------|-----------------|-----|-----|----|-----|-----|-----|-----|-----|-----|------------------------|--|-----|-----|-----|
|                 |               |       |                        | B               | C   | L   | R  | J   | K   | G   | H   | W   | M   |                        |  |     |     |     |
|                 |               |       |                        |                 |     |     |    |     |     |     |     |     | LK/ |                        | GLS  | DB  | LK  | GLS |
| 9x27            | 1600          | 1     | 12                     | 26              | 514 | 210 | 22 | 133 | 240 | 473 | 716 | 290 | 554 | 668                    | 1.8  | 133 | 138 | 142 |
|                 |               |       | 40 (*)                 |                 |     |     |    |     | 494 | 655 | 930 | 300 |     |                        |  |     |     |     |
|                 | 3200          | 2     | 12 (**)                | 35              | 699 | 357 | 25 | 175 | 282 | 473 | 716 | 290 | 554 | 668                    |  | 137 | 142 | 146 |
|                 |               |       | 40 (*, **)             |                 |     |     |    |     | 536 | 655 | 930 | 300 |     |                        |  |     |     |     |

GLS: Gear Limit Switch  
 DB : Double Brake

(\*) For these heights of lift, customer has to link the chain bag to the structure.  
 (\*\*) In case of 2-fall hoist, available lifting height is half of the chain bag maximum capacity.