

Fixed to electric travel trolley TMU-C3 max 3 TON (perpendicular version)

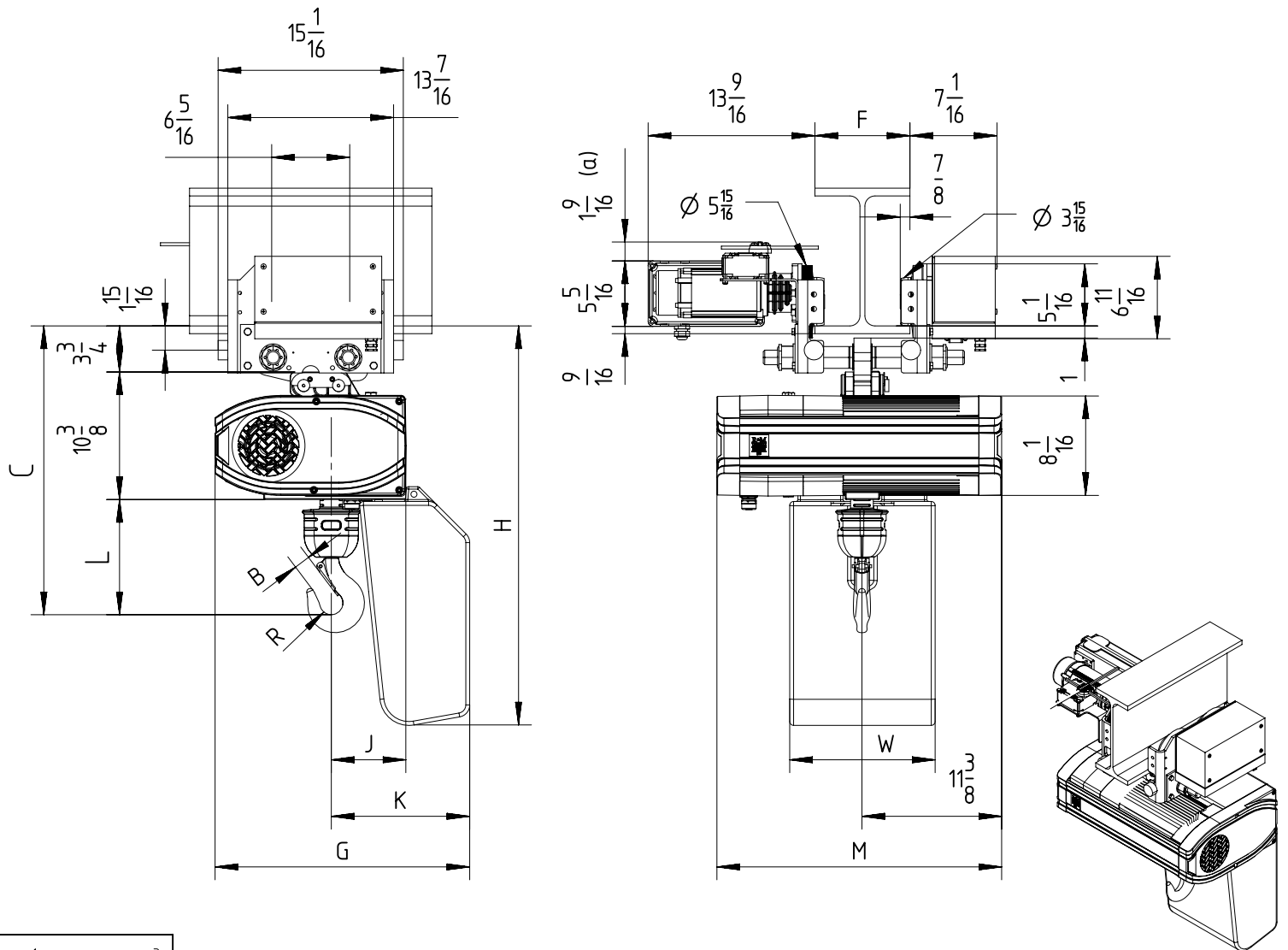

$$3\frac{1}{4} < F < 12\frac{3}{16}$$

(a) Note: Trolley limit switch is optional.  
 Note: In case of 2-fall hoist, coupling suspension is rotated by 180°.  
 Note: Mini. radius of curve for trolley 3 TON is 6.56ft.  
 Note: Add 2 $\frac{3}{8}$  inch to C & L dimension for hoisting speeds greater than 32 fpm.

Chain Size (mm)	Max load (TON)	Falls	Chain bag capacity (ft)	Dimensions (inch)										Weight of chain (lb/ft)	Estimated weight of hoist incl. trolley w/o chain (lb)			
				B	C	L	R	J	K	G	H	W	M		LK	GLS	DB	
													LK/GLS					DB
11.3x31	2 $\frac{1}{2}$	1	39	1 $\frac{5}{16}$	23 $\frac{7}{16}$	9 $\frac{3}{8}$	15 $\frac{1}{16}$	6 $\frac{1}{16}$	11 $\frac{1}{4}$	20 $\frac{11}{16}$	32 $\frac{7}{16}$	11 $\frac{13}{16}$	23 $\frac{1}{8}$	27 $\frac{15}{16}$	1.9	350	362	364
			98 (*)						17 $\frac{7}{16}$	26 $\frac{7}{8}$	37 $\frac{3}{16}$							
	3	2	39 (**)	1 $\frac{5}{8}$	27 $\frac{3}{8}$	15 $\frac{1}{4}$	1 $\frac{1}{8}$	8 $\frac{1}{8}$	13 $\frac{1}{8}$	20 $\frac{11}{16}$	32 $\frac{7}{16}$	11 $\frac{13}{16}$	23 $\frac{1}{8}$	27 $\frac{15}{16}$	1.9	359	370	373
			98 (*, **)						19 $\frac{5}{16}$	26 $\frac{7}{8}$	37 $\frac{3}{16}$							

GLS: Gear Limit Switch  
 DB: Double Brake

(\*) For big height of lift, customer has to link the chain bag to the structure.  
 (\*\*) In case of 2-fall hoist, available lifting height is half of the chain bag maximum capacity.