



1/4 TON TO 3 TON CAPACITY RL MANUAL LEVER PULLER

English

STD-R-KHA-F-CQD-ENG



R&M Materials Handling, Inc. | 4501 Gateway Boulevard, Springfield, Ohio 45502 | PH: 1-937-525-5100 | www.rmhoist.com

This document and the information contained herein, is the exclusive property of R&M Materials Handling, Inc., and represents a non-public, confidential and proprietary trade secret that may not be reproduced, disclosed to third parties, altered or otherwise employed in any manner whatsoever without the express written consent of R&M Materials Handling, Inc. Copyright © (2009) R&M Materials Handling, Inc. All rights reserved.

6.2 3/4 ton [750 kg] and higher capacity units

Figure 6. Spare Parts Diagram

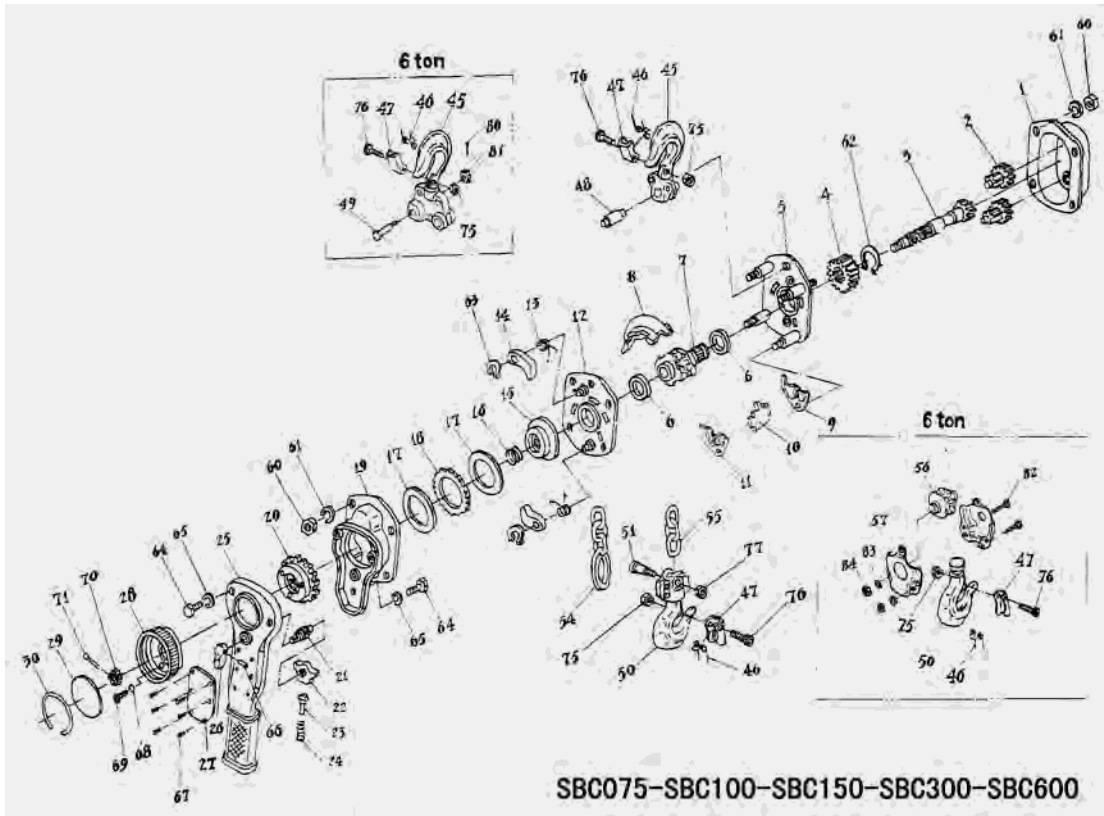

Table 5. Spare Parts List

Item	Description	Part Number	Qty	Item	Description	Part Number	Qty
1	Gear case assembly		1	45	Top hook assembly 1 1/2 ton [1500 kg]	52291857	1
2	Driven shaft assembly		2	45	Top hook assembly 3 ton [3000 kg]	52291858	1
3	Drive shaft		1	46	Double spring		1/ hook
4	Splined gear		1	47	Safety latch 3/4 ton [750 kg]	52308673	1/ hook
5	Side Plate assembly A		1	47	Safety latch 1 1/2 ton [1500 kg]	52308674	1/ hook
6	Bushing		2	47	Safety latch 3 ton [3000 kg]	52308676	1/ hook
7	Load sheave		1	48	Top pin		1
8	Guide plate		1	50	Load hook assembly	52291851	1
9	Chain leader A		1	50	Load hook assembly	52291697	1
10	Stripper		1	50	Load hook assembly	52291853	1
11	Chain leader B		1	51	Chain pin		1
12	Side plate assembly B		1	54	Chain ring		1
13	Pawl spring		2	55	Load chain 6 x 18	900545	
14	Pawl		2	55	Load chain 7.1 x 21	52288023	
15	Disk hub		1	55	Load chain 10 x 30	52288024	
16	Free spring		1	60	Hexagon nut M8		8
17	Friction disk		2	61	Spring washer 8		8
18	Ratchet disk		1	62	Snap ring 26		1
19	Brake cover assembly		1	63	Snap ring 8		2
20	Change over gear		1	64	Screw M6x10		3
21	Selector shaft		1	65	Spring washer 6		3
22	Change over pawl		1	66	Spring pin 2.5x18		1
23	Spring shaft		1	67	Rivet 2.5x6		6
24	Change over spring		1	68	Spring washer 5		3
25	Lever handle assembly		1	69	Screw M5x10		3
26	Selector lever		1	70	Castle nut M10		1
27	Name plate		1	71	Split pin 2.5x20		1
28	Hand wheel		1	75	Prevailing torque type nut M3		2
29	Indicator cap		1	76	Screw M3x18		2
30	Retainer wire		1	77	Prevailing torque type nut M8		1
45	Top hook assembly 3/4 ton [750 kg]	52291855	1				



Note: Items without part numbers are non-stocked replacement parts.