

### TOP JOINT PLATE TYPE K

### RTN32B END TRUCK

This document is the absolute property of R&M Materials Handling, Inc. This document must not be copied without the written permission of R&M Materials Handling, Inc. The contents thereof must not be disclosed to a third party nor be used for any unauthorized purpose. Contravention will be prosecuted.

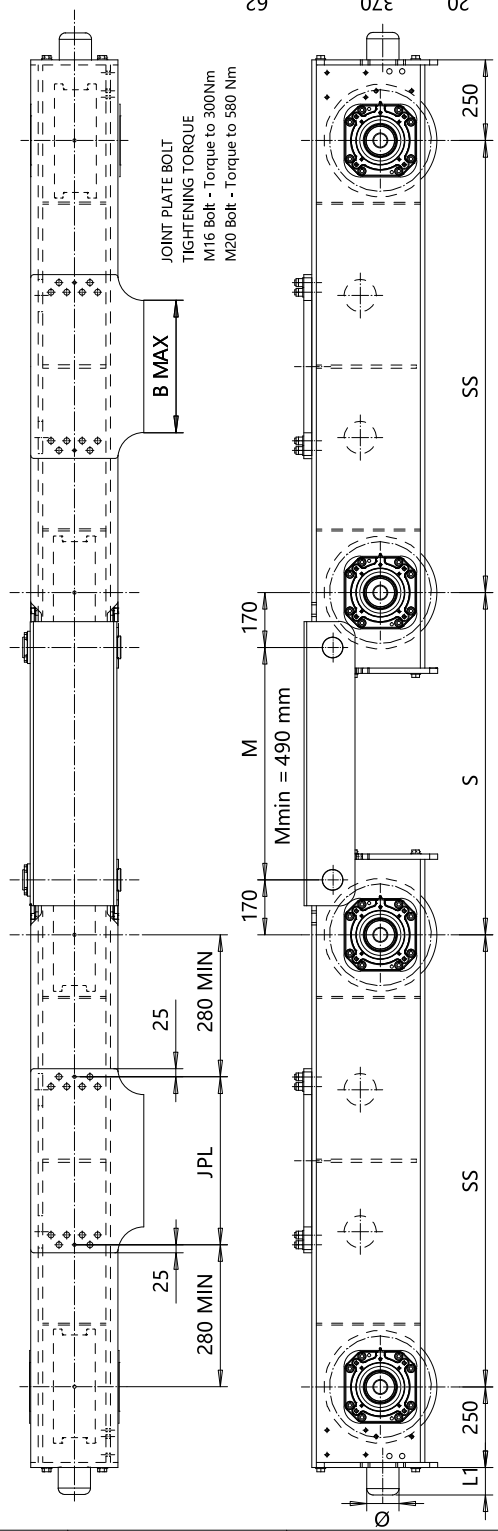

Product Code example

**RTN32B1474-K41940C0000-N**

- N=standard, E=Special
- primer paint, color code (not in use with RTN32)
- Buffer type
- Joint plate distance, mm (pin to pin, with DG)
- Joint plate code
- 1WD, D=2WD (Number of driving wheels/truck)
- Wheel groove = UU, mm
- Wheel base = SS, mm
- std, B=toggle
- Type of end carriage

Joint plate	JPL (mm)	B max (mm)
K4	520	410
K5	630	520
K7	850	740
K9	1100	990

Minimum wheelbase with K9 joint plate is 1600 mm.

The wheel loads listed are only a guideline. The max. wheel load listed is based on the structural integrity of the frame and load placement, and it does not take into account permissible wheel loading or bearing life. Load placement is assumed at the center of each truck.

The permissible dynamic wheel load listed is based on assumptions that the bridge speed is 40 m/min (130 fpm), end truck duty is Fem 2m, and the runway rail is as listed.

The actual wheel load should not exceed the permissible wheel load. If the permissible dynamic wheel load is greater than the maximum dyn wheel load, then the actual wheel load cannot exceed maximum dyn wheel load.

Dynamic wheel load = 1.15 x static wheel load

Buffer type	L1, (mm)	Ø, (mm)
B	68	80
C	85	100
D	105	125
E	150	100
F	190	125
H	160	160
I	200	200
M	125	125
P	240	160
S	300	200
T	350	250
Y	475	250

B, C, D rubber  
 E, F, H, I, M, P, S, T, Y polyurethane

Wheelbase code	SS (mm)	Max dyn whl load (kN)	Permissible dyn whl load, (kN)	Approx Wt./Trk, kg
14	1400	253	ASCE 40 112, ASCE 60 150, ASCE 85 166.5, BETH 135 219	1032
16	1600	253	ASCE 40 112, ASCE 60 150, ASCE 85 166.5, BETH 135 219	1085
18	1800	253	ASCE 40 112, ASCE 60 150, ASCE 85 166.5, BETH 135 219	1137
20	2000	253	ASCE 40 112, ASCE 60 150, ASCE 85 166.5, BETH 135 219	1189

Rev	Description	Specification	ETTPA Cnd	Appd	Ref Drawing
1	Design	2008-08-11	END TRUCK		
2	Issue	SLE000CV	OUTLINE DRAWING		
3	Revised	R&M MATERIALS HANDLING, INC.	RTN32B-K		
4	Revised	R&M MATERIALS HANDLING, INC.	RTN32B END TRUCK TOP JOINT		