

RU20 UNDER RUNNING END TRUCK

Wheelbase code	Wheelbase	Max Dyn. Corner Load (kips)	L	Approx. Wt. (lbs)	H
18	SS	32.355	97.64"	1581	11 13/16"
23	5'-10 7/8"	32.355	117.32"	1711	11 13/16"
28	9'-2 1/4"	32.355	137"	1839	11 13/16"
32	10'-6"	32.355	152.75"	2161	14 5/16"
35	11'-5 13/16"	32.355	164.57"	2240	14 5/16"
40	13'-1 1/2"	32.355	184.25"	2497	14 5/16"

Dyn Load = 1.15 * Static Load

Buffer type	L1	D1
A	2 1/4"	2 1/2"
B	2 11/16"	3 3/16"
C	3 5/16"	3 15/16"
D	4 1/8"	4 15/16"
E	5 15/16"	3 15/16"
F	7 1/2"	4 15/16"
G	4"	4"
K	3 3/16"	3 3/16"
M	4 15/16"	4 15/16"

A, B, C, D rubber
 E, F, G, K, M polyurethane

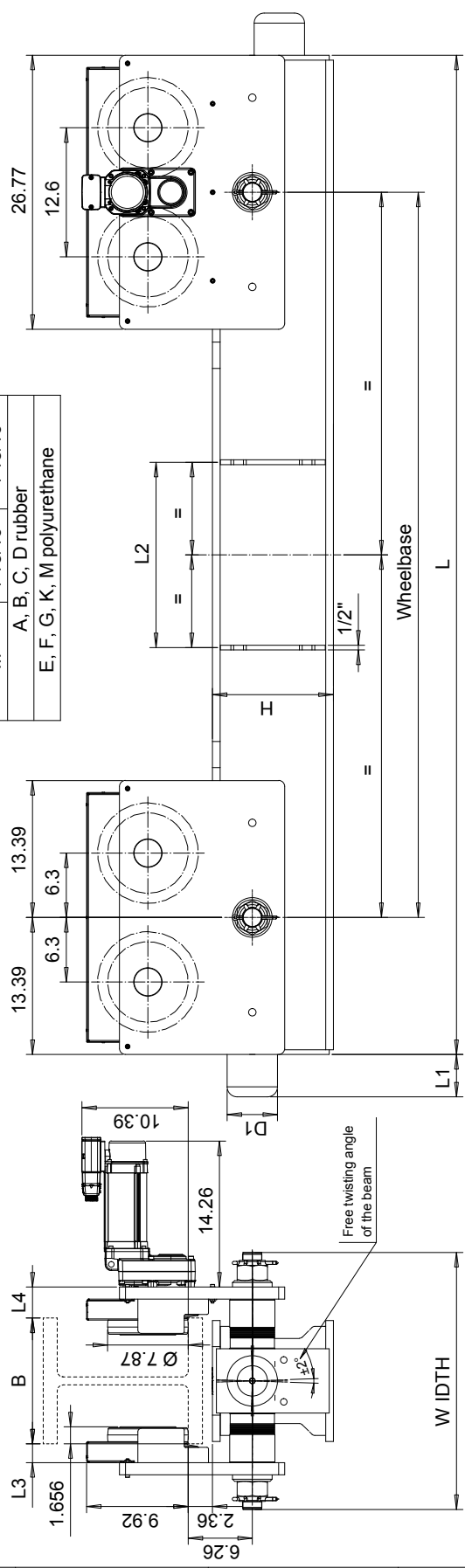

Joint Plate Type	L2
No Joint Plate	18 1/8"
SD3, BD3, BD4	18 1/8"
SD4, BD5	22 1/16"
SD5	26"

Flange width range, B	L3	L4	WIDTH
5" - 8 1/4"	1.81"	3"	21 1/32"
8 5/16" - 12 3/8"	1.81"	3"	25 1/8"
12 7/16" - 16 1/2"	1.81"	3"	29 1/4"

No patented track option

Pos	Description	Specification	Id	Drawing
ETTPA Design	ETTPA Chd	ETTPA Chd		Ref Drawing
2012-04-11	END TRUCK	END TRUCK		
SLEDDOCV	OUTLINE DRAWING	OUTLINE DRAWING		
	RU20	RU20		
	RU20 END TRUCK	RU20 END TRUCK		

R&M MATERIALS HANDLING, INC.
 1-7 Foster
 3/2018