

FOOT MOUNT, 4 PART SINGLE

Hoist type:

SX2 041..F0

SX3 041..F0

US-60Hz

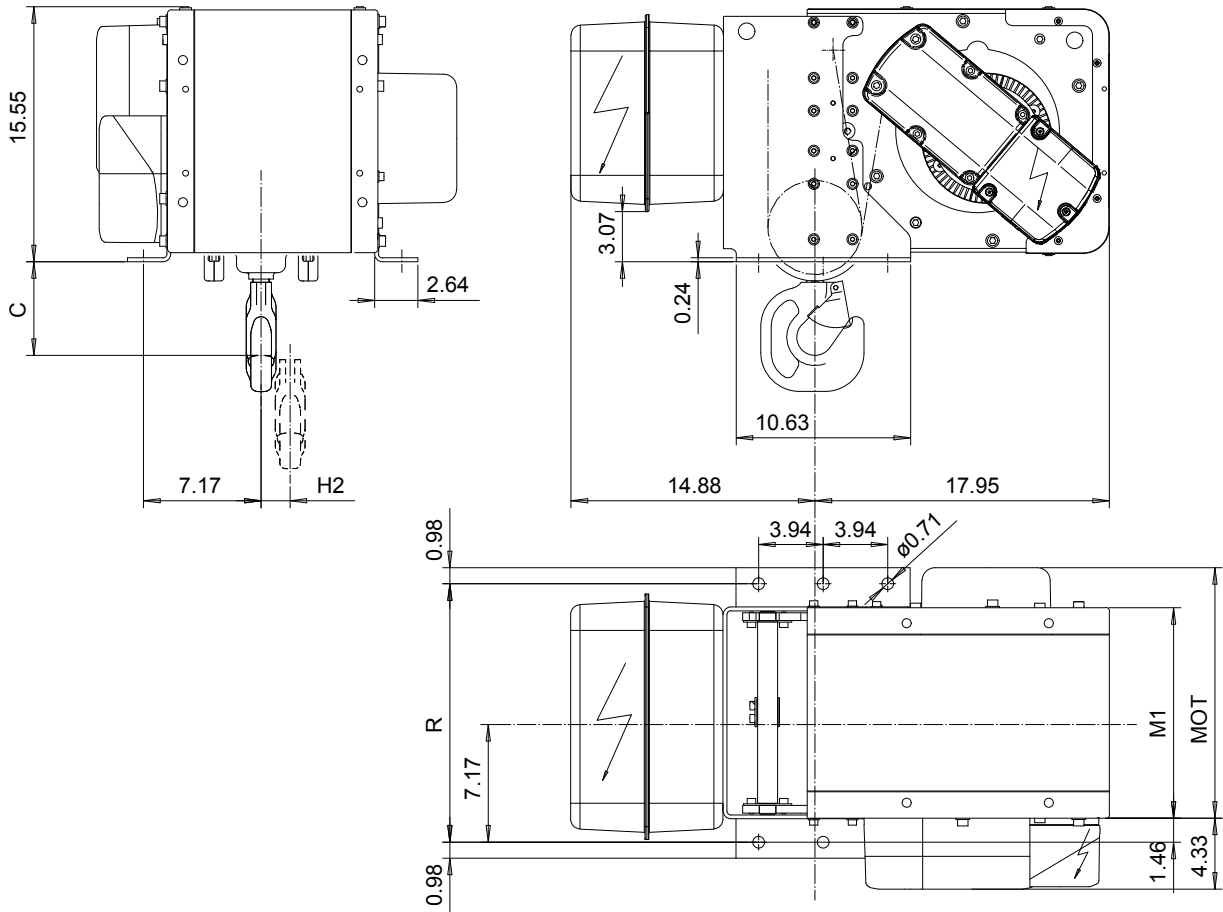

Motor	P1	P2	P3	A3	S3
MOT (in)	15.2	17.6	18.7	17.6	20.7
Weight (lb)	46	68	77	71	62

HOL (ft)	Length code	M1 (inch)	H2 (inch)	R (inch)	Approx Weight (lb)
19'-8"	A	12.84	1.77	15.75	250
31'-2"	C	17.95	2.83	20.87	270

Headroom - C dimension	
Standard	5.71"
with HS22 Hook operated limit switch	14.8"

Load (ton)	Class ASME
1 1/2	H4+
2	H4
2 1/2	H4+
3	H4

Approx. weight calculated with P1 motor.

This document is the absolute property of R&M Materials Handling, Inc. This document must not be copied without the written permission of R&M Materials Handling, Inc. The contents thereof must not be disclosed to a third party nor be used for any unauthorized purpose. Contravention will be prosecuted.

Design	Chd	Appd	Ref Drawing	QA-F-04
Date	HOIST; FIXED			
SLEIGH/CE Owner Dept	4 ROPE FALLS			
R&M MATERIALS HANDLING INC.	R&M MATERIALS HANDLING INC HOIST & CRANE PRODUCTS SPRINGFIELD, OHIO	D002078-A		Issue 8