

Low Headroom Hoist EXSX4, REEVING: 021; Class I, Division 1

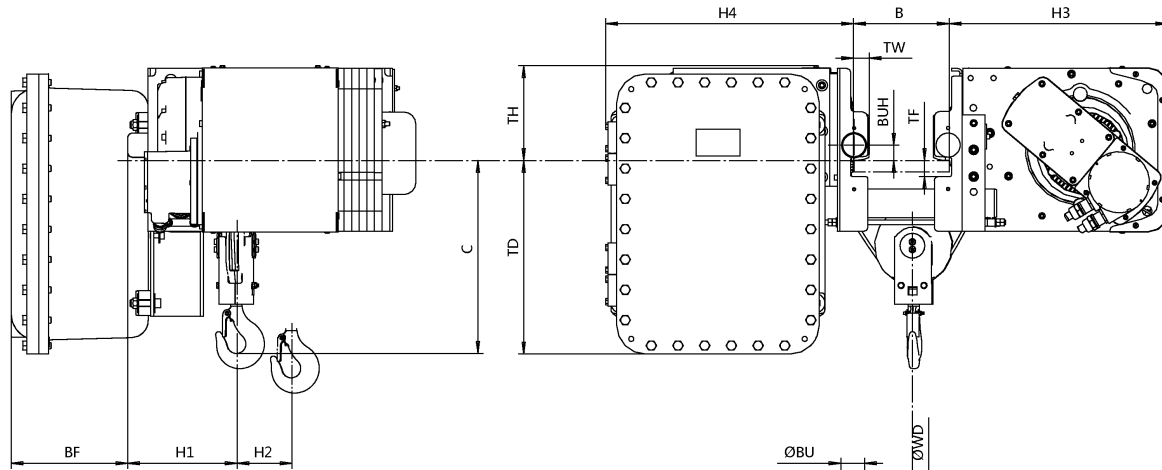

C-dimensions

B	C
100 - 250	440
251 - 300	470
301 - 350	505
351 - 400	535
401 - 450	570
451 - 490	595

Note: All dimensions in mm.

Note: Weight calculated with E1 and MF07E motors when B=300 mm.

* Please, disregard the dimension H3*.

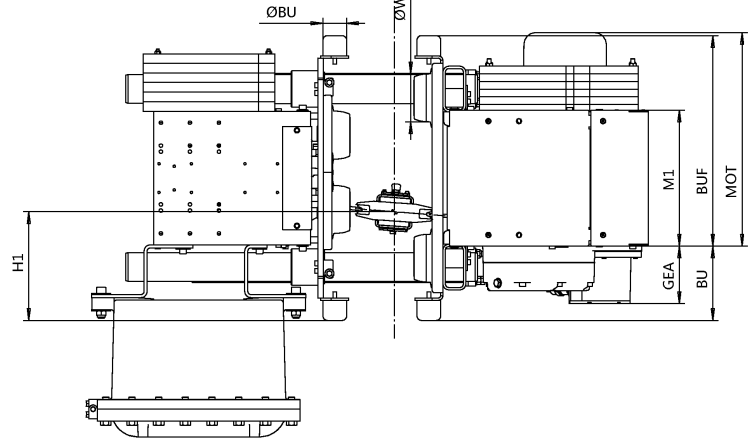

D007721-A

Hoist dimensions

HOL	Length	M1	H1	H2	H3	H3*	H4	BUF	Weight
m	code	mm	mm	mm	mm	mm	mm	mm	kg
12	B	356	285	95	573	589	649	551	810
18	C	456	285	144	573	589	649	651	840
24	D	556	285	193	573	589	649	751	900

Motor dimensions

Motor	E1	E2
MOT (mm)	565	565
Weight (kg)	70	70

Traveling dimensions

Motor	MF07E
Weight (kg)	13

Trolley dimensions

B min.	B max.	ØWD	ØBU	BF	BU	BUH	GEA	TD	TF	TH	TW
100	490	125	63	305	195	40	151	507	42	255	41.5

D007721-A
314908