

DOUBLE GIRDER, MEDIUM, 8 PART SINGLE
Hoist type:
SX5 081...D0

US-60Hz

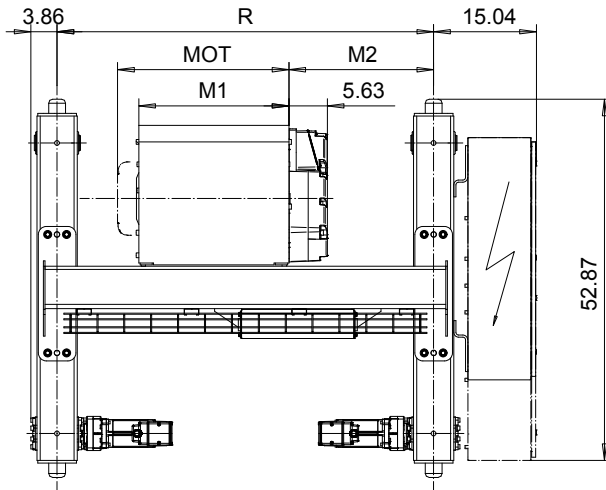
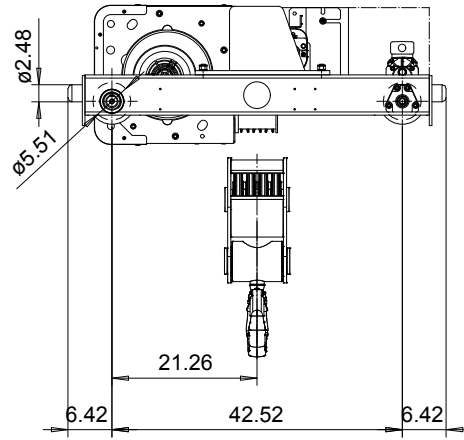
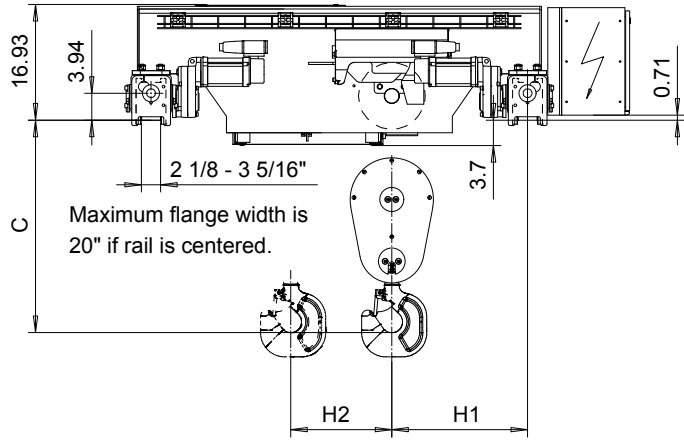

Headroom - C dimension	
Standard	31.1"
with HS22 Hook operated limit switch	33.1"

Motor	P5	P6	P7	A5	S5	S7
MOT (in)	22.76	22.76	24.33	19.61	23.86	29.8
Weight (lb)	128	187	231	99	117	179

Load (TON)	Class ASME
15	H4
20	H3

HOL	Length code	M1 (inch)	M2 (inch)	R (inch)	H1 (inch)	H2 (inch)	Approx. Weight (lb)
14'-9"	D	21.97	21.18	55.12	19.88	1.73	1698
19'-8"	E	26.69	29.84	66.93	28.54	2.09	1797
26'-2"	F	32.6	35.94	78.74	34.65	2.99	1907
32'-9"	G	40.08	44.12	94.49	42.19	3.86	2039

Note:

R is standard gauge, minimum gauge for second brake or service platform

Standard rail gauge increments: 4'-7 1/8", 5'-6 7/8", 6'-6 3/4", 7'-10 1/2"

Approx. Weight calculated with P5 motor.

This document is the absolute property of R&M Materials Handling, Inc. This document must not be copied without the written permission of R&M Materials Handling, Inc. The contents thereof must not be disclosed to a third party nor be used for any unauthorized purpose. Contravention will be prosecuted.

ETTPAL Design 2002-08-30 Date SLEQDQCV Drawn (Date)	ETTPAL Chd Appnt Ref Drawing	QC-M-08
TROLLEY; DOUBLE GIRDER		1:12
MEDIUM, 8 ROPE FALLS		Folder
R&M MATERIALS HANDLING INC.	R&M MATERIALS HANDLING, INC HOIST & CRANE PRODUCTS SPRINGFIELD, OHIO	Issue 3
D007195-A		