

Double Girder Hoist EXSX5, REEVING: 061; Class I, Division 2

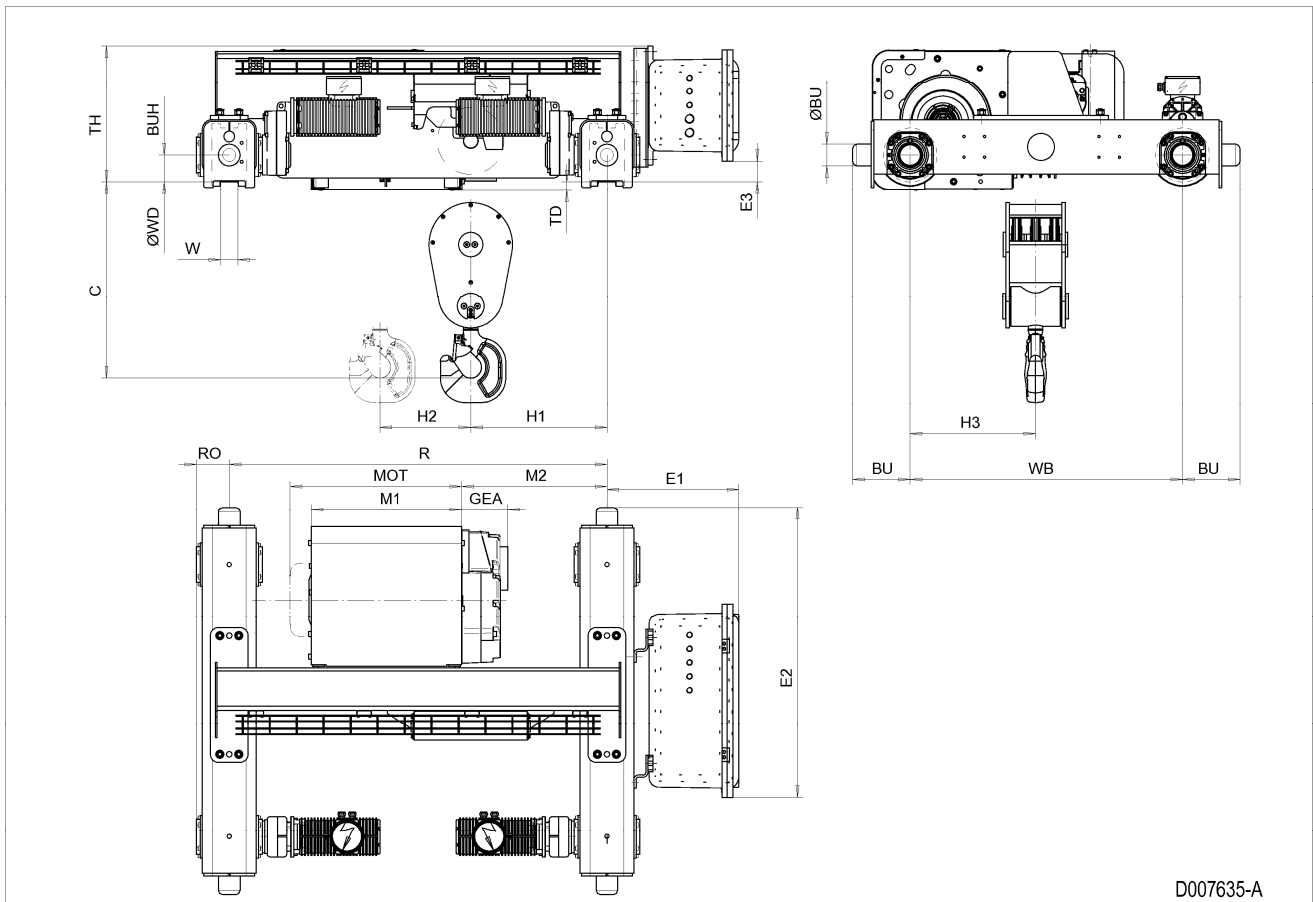

D007635-A

Hoist dimensions

HOL m	Length code	M1 mm	M2 mm	H1 mm	H2 mm	Min R mm	Weight kg
6	D	558	538	505	53	1400	1168
8	E	678	758	725	78	1700	1218
10	F	828	913	880	98	2000	1274
13	G	1018	1123	1090	132	2400	1345

Motor dimensions

Motor	P5	P6
MOT (mm)	578	578
Weight (kg)	58	85

Trolley dimensions

C	ØBU	BU	BUH	E1	E2	E3	GEA	H3	WB	ØWD	W min
728	80	213	100	488.8	1076.7	77.5	170	465	1010	200	54
W max	RO	TD	TH								
99	122	32	504.6								

D007635_A
252851

Note: Weight calculated with P5 motor.

Note: All dimensions in mm.

Note: Min R with service platform.

Note: Standard rail gauges: 1400, 1700, 2000 and 2400.

Note: M2 and weight calculated with Min R.

Note: Flangeless wheels available.