

Double Girder Hoist EXSX5, REEVING: 061; Class I, Division 2

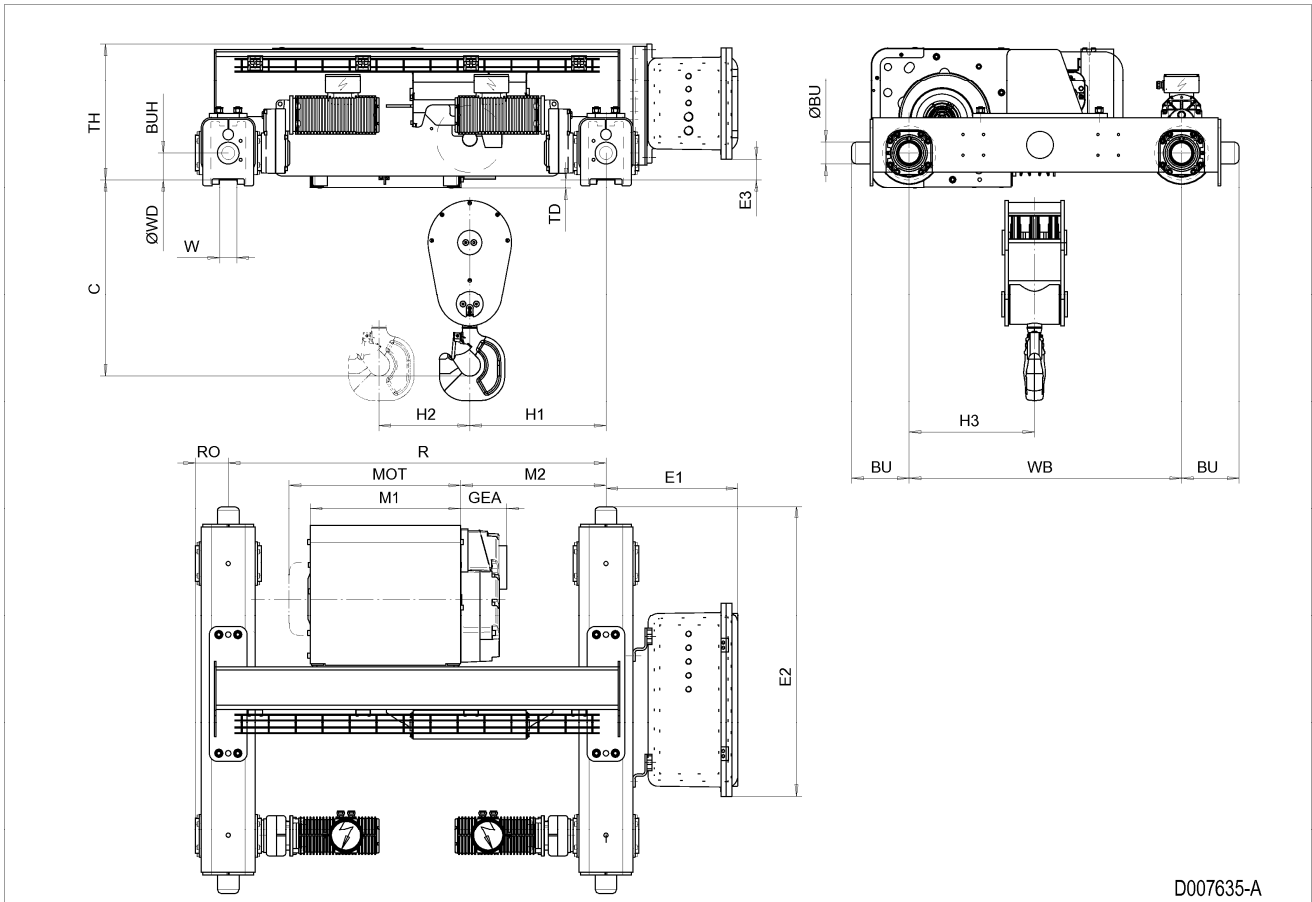

D007635-A

Hoist dimensions

HOL ft	Length code	M1 inch	M2 inch	H1 inch	H2 inch	Min R inch	Weight lb
19'-8"	D	21.97	21.18	19.88	2.09	55.12	2575
26'-3"	E	26.69	29.84	28.54	3.07	66.93	2686
32'-10"	F	32.6	35.94	34.65	3.86	78.74	2809
42'-8"	G	40.08	44.21	42.91	5.2	94.49	2966

Motor dimensions

Motor	P5	P6
MOT (inch)	22.76	22.76
Weight (lb)	128	187

Trolley dimensions

C	ØBU	BU	BUH	E1	E2	E3	GEA	H3	WB	ØWD	W min
28.66	3.15	8.39	3.94	19.24	42.39	3.05	6.69	18.31	39.76	7.87	2.13
W max	RO	TD	TH								
3.9	4.8	1.26	19.87								

D007635_A
252851

- Note: Weight calculated with P5 motor.
- Note: All dimensions in inch.
- Note: Min R with service platform.
- Note: Standard rail gauges: 55.1, 66.9, 78.7 and 94.5.
- Note: M2 and weight calculated with Min R.
- Note: Flangeless wheels available.