

Normal Headroom Hoist EXSX5, REEVING: 082; Class I, Division 2

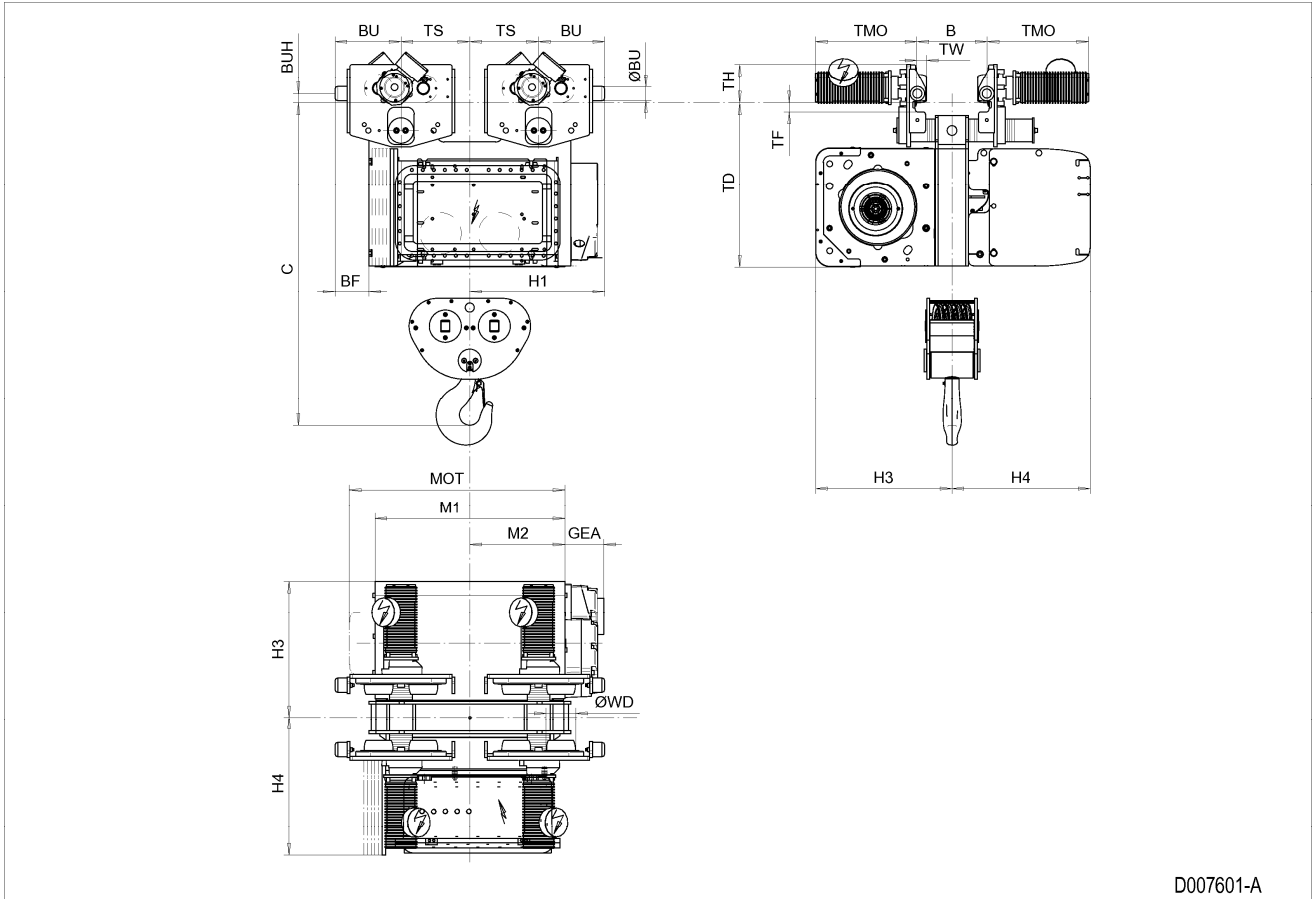

D007601-A

Hoist dimensions

HOL ft	Length code	M1 inch	M2 inch	H1 inch	H3 inch	H3* inch	H4 inch	Weight lb
14'-9"	F	32.6	16.3	23.15	23.43	24.21	23.7	2527
19'-8"	G	40.08	20.04	31.02	23.43	24.21	23.7	2809
26'-3"	H	49.92	24.96	31.02	23.43	24.21	23.7	3050
37'-9"	J	63.7	31.85	31.02	23.43	24.21	23.7	3272

Motor dimensions

Motor	P5	P6	E4	E6
MOT (inch)	22.76	22.76	26.89	26.89
Weight (lb)	128	187	320	320

Traveling dimensions

Motor	MF06LA
TMO (inch)	15.67
Weight (lb)	17

Trolley dimensions

B min	B max	C	ØBU	ØWD	BU	BUH	GEA	TD	TF	TH	TW
3.94	24.02	55.43	2.48	4.92	11.34	1.57	6.69	28.19	1.57	6.69	1.63

Trolley dimensions

Length code	BF	TS
F	5.83	11.81
G/H/J	-1.65	19.69

D007601_A
252556

Note: Weight calculated with P5 and MF06LA motors, when B=11.8 inch.

Note: All dimensions in inch.

* Please, disregard the dimension H3*.