

Fixed Hoist EXSX6, REEVING: 041; Class I, Division 2

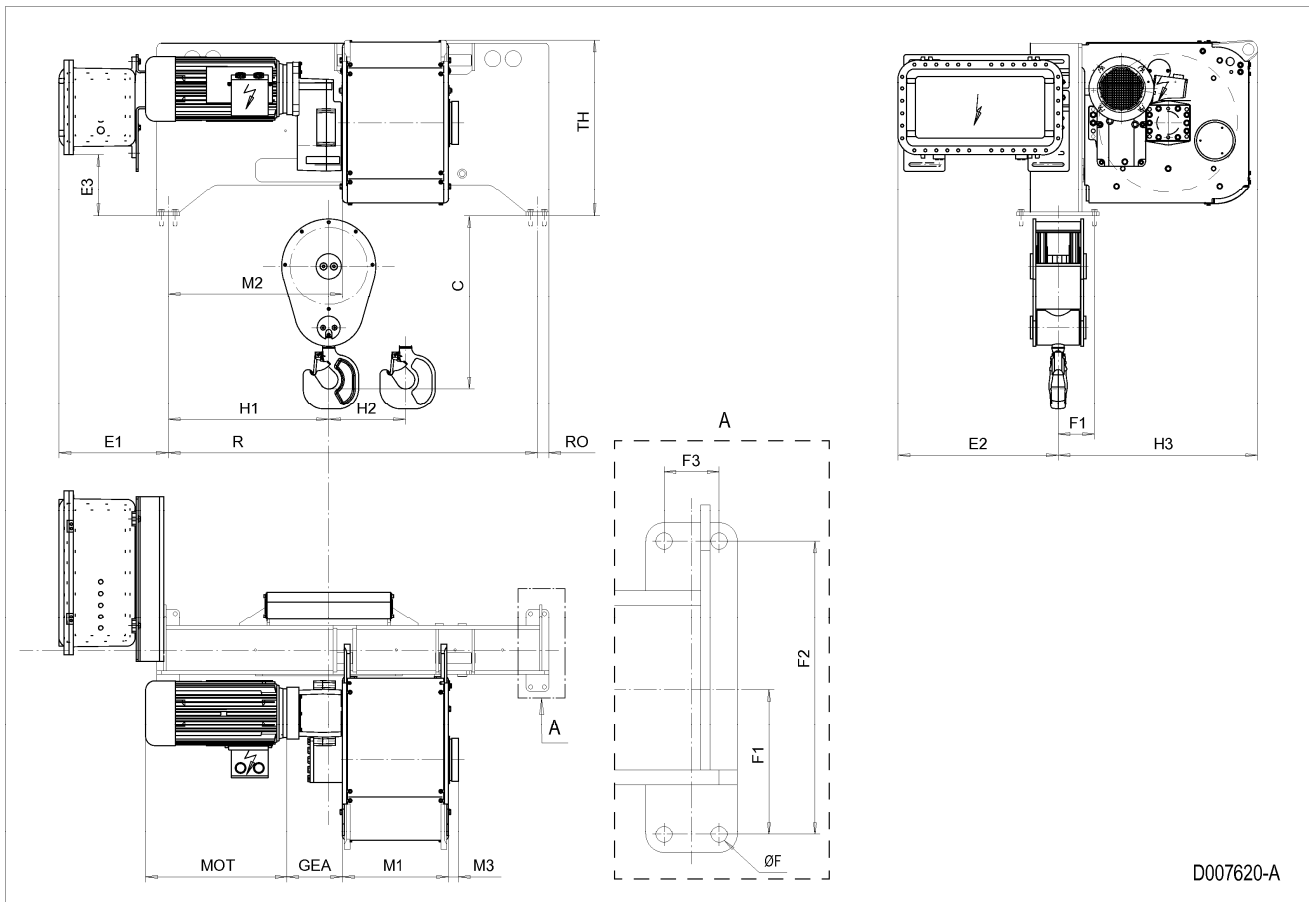

D007620-A

HOL m	HOL* m	Length code	R mm	M1 mm	M2 mm	H1 mm	H2 mm	Weight** kg
7.5	4.5	C	1610	462	760	700	69	1600
10.5	7.5	D	1610	562	760	700	94	1700
14	11	E	1840	682	710	650	125	1700
18	15	F	1840	832	710	650	161	1800
23.5	20.5	G	2350	1022	790	730	210	1900
30.5	27.5	H	2350	1272	790	730	273	2000
40	37	J	2669	1622	750	690	360	2300
48.5	45.5	K	2669	1922	750	690	434	2400

*HOL with drum brake

**Presence of a drum brake increases weight by 80 kgs.

Motor dimensions

Motor	P6
MOT (mm)	536
Weight (kg)	86

Trolley dimensions

C	ØF	E1	E2	E3	F1	F2	F3	GEA	H3	M3	RO
754	18	476.6	698.6	269.1	158.5	320	60	218	871	44	50
TH											
768											

D007620_A
252829

Note: Weight calculated with P6 motor.

Note: All dimensions in mm.