

Normal Headroom Hoist EXSX6, REEVING: 041; Class I, Division 2

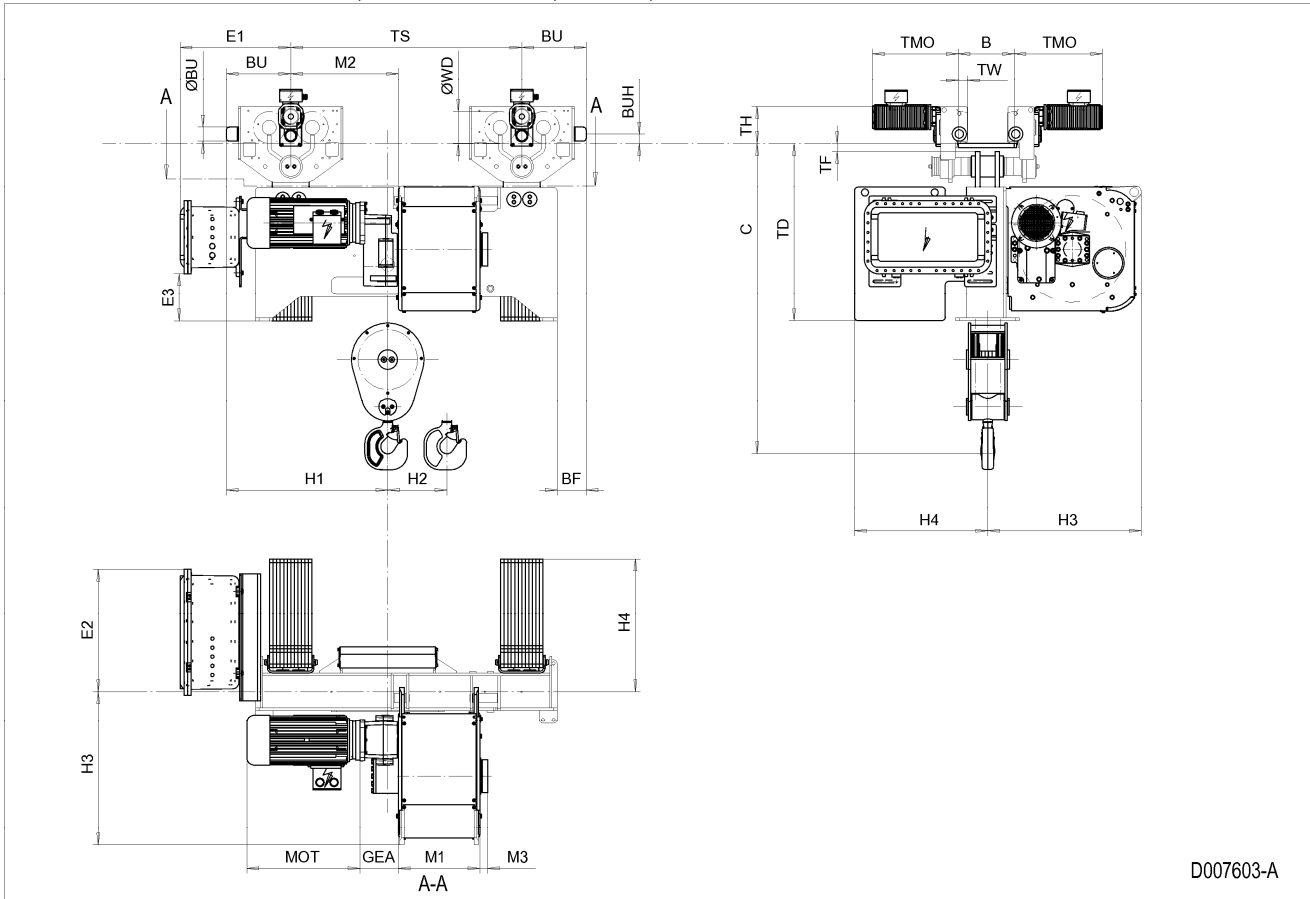

D007603-A

HOL ft	HOL* ft	Length code	M1 inch	M2 inch	TS inch	BF inch	H1 inch	H2 inch	H3 inch	H4 inch	Weight** lb
24'-7"	16'-5"	C	18.19	24.02	51.57	6.5	36.02	2.72	34.29	29.76	5513
34'-5"	26'-3"	D	22.13	24.02	51.57	6.5	36.02	3.7	34.29	29.76	5733
45'-11"	37'-9"	E	26.85	22.05	41.73	-12.4	34.06	4.92	34.29	29.76	5954
59'-1"	50'-10"	F	32.76	22.05	41.73	-12.4	34.06	6.34	34.29	29.76	6395
77'-1"	68'-11"	G	40.24	25.2	55.12	-19.09	37.2	8.27	34.29	29.76	6615
100'-1"	91'-10"	H	50.08	25.2	55.12	-19.09	37.2	10.75	34.29	29.76	6836
131'-3"	123'-0"	J	63.86	23.62	55.12	-31.65	35.63	14.17	34.29	29.76	7938
159'-1"	150'-11"	K	75.67	23.62	55.12	-31.65	35.63	17.09	34.29	29.76	8379

*HOL with drum brake

**Presence of a drum brake increases weight by 176 lbs.

Motor dimensions

Motor	P6
MOT (inch)	21.1
Weight (lb)	190

Traveling dimensions

Motor	MF06LA
TMO (inch)	18.86
Weight (lb)	17

Trolley dimensions

B min	B max	C	ØWD	ØBU	BU	BUH	E1	E2	E3	GEA	M3
4.72	24.02	69.37	7.09	3.15	14.37	2.09	24.67	27.44	10.59	8.58	1.73
TD	TF	TH	TW								
39.69	1.75	8.19	2.09								

D007603_A

252559

Note: Weight calculated with P6 and MF06LA motors when B=11.8 inch.

Note: All dimensions in inch.