

Normal Headroom Hoist EXSX6, REEVING: 041; Class I, Division 2

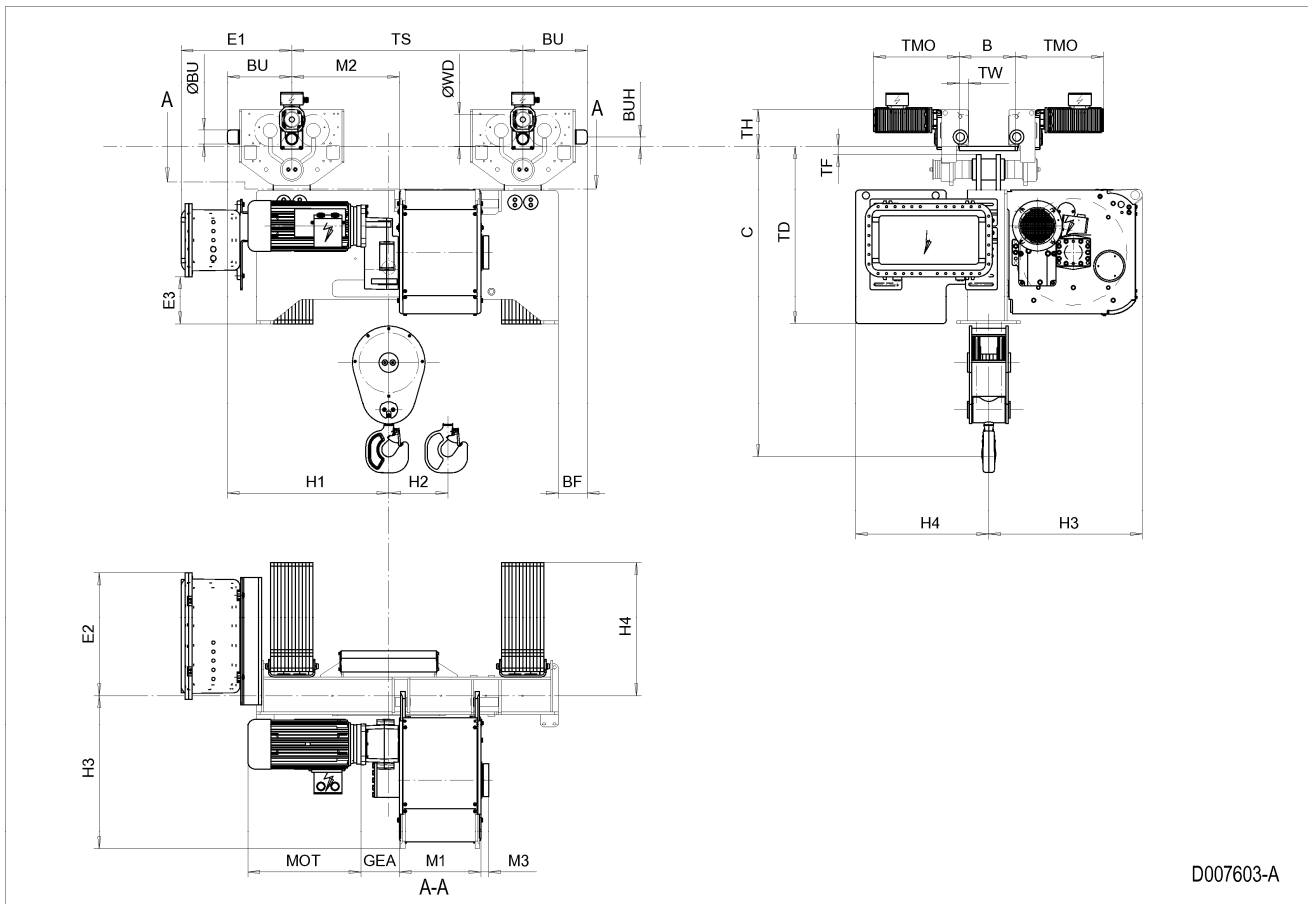

D007603-A

HOL m	HOL* m	Length code	M1 mm	M2 mm	TS mm	BF mm	H1 mm	H2 mm	H3 mm	H4 mm	Weight** kg
7.5	5	C	462	610	1310	165	915	69	871	756	2500
10.5	8	D	562	610	1310	165	915	94	871	756	2600
14	11.5	E	682	560	1060	-315	865	125	871	756	2700
18	15.5	F	832	560	1060	-315	865	161	871	756	2900
23.5	21	G	1022	640	1400	-485	945	210	871	756	3000
30.5	28	H	1272	640	1400	-485	945	273	871	756	3100
40	37.5	J	1622	600	1400	-804	905	360	871	756	3600
48.5	46	K	1922	600	1400	-804	905	434	871	756	3800

*HOL with drum brake

**Presence of a drum brake increases weight by 80 kg.

Motor dimensions

Motor	P6
MOT (mm)	536
Weight (kg)	86

Traveling dimensions

Motor	MF06LA
TMO (mm)	479
Weight (kg)	7.8

Trolley dimensions

B min	B max	C	ØWD	ØBU	BU	BUH	E1	E2	E3	GEA	M3
120	610	1762	180	80	365	53	626.6	697.1	269.1	218	44
TD	TF	TH	TW								
1008	44.5	208	53								

D007603_A
252559

Note: Weight calculated with P6 and MF06LA motors when B=300 mm.

Note: All dimensions in mm.