

Normal Headroom Hoist EXSX6, REEVING: 061; Class I, Division 2

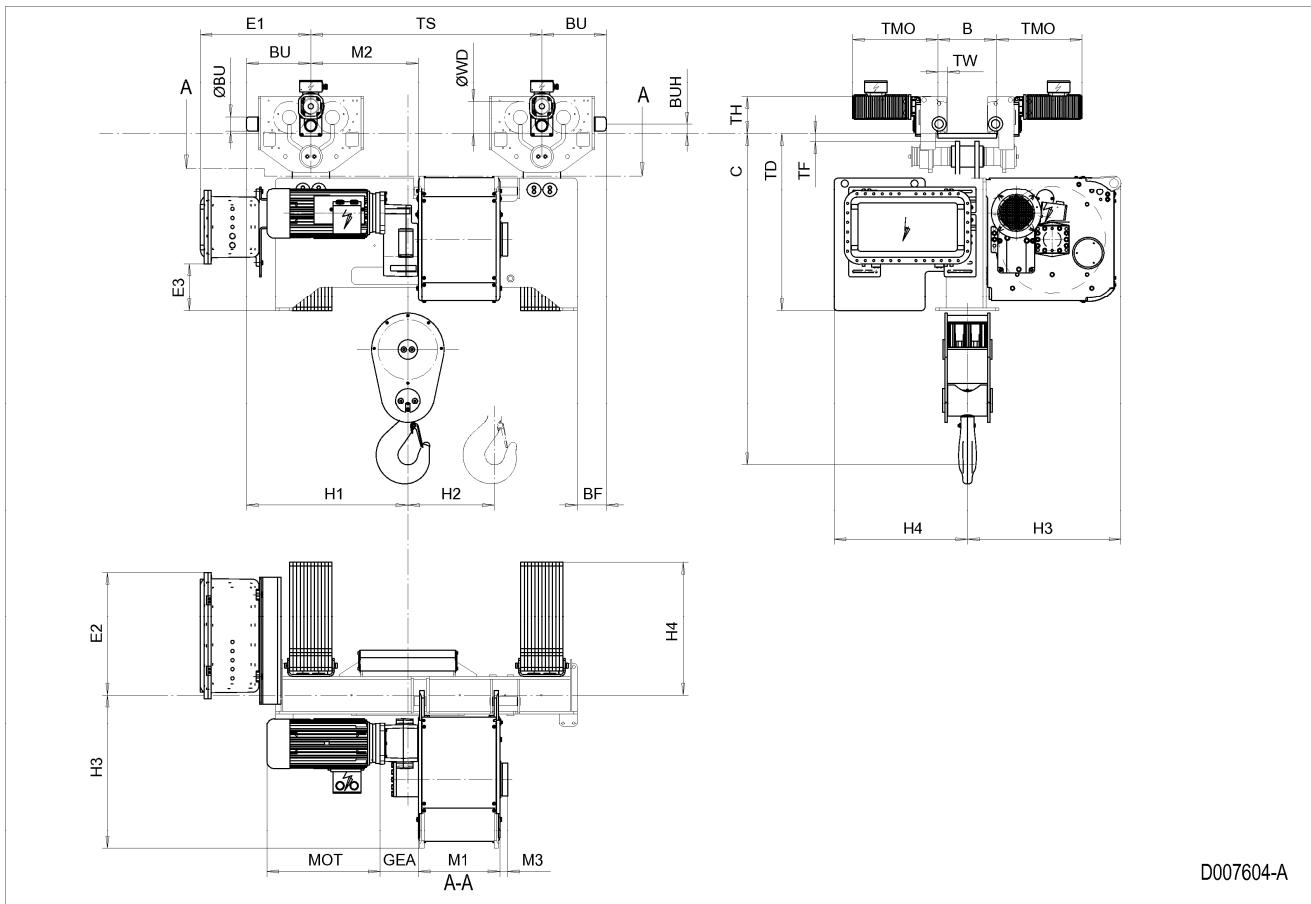

D007604-A

HOL ft	HOL* ft	Length code	M1 inch	M2 inch	TS inch	BF inch	H1 inch	H2 inch	H3 inch	H4 inch	Weight** lb
16'-5"	11'-6"	C	18.19	24.02	51.57	6.5	36.02	1.81	34.29	29.76	5733
22'-12"	18'-1"	D	22.13	24.02	51.57	6.5	36.02	2.48	34.29	29.76	5954
29'-6"	24'-7"	E	26.85	22.05	41.73	-12.4	34.06	3.31	34.29	29.76	6174
39'-4"	34'-5"	F	32.76	22.05	41.73	-12.4	34.06	4.21	34.29	29.76	6395
50'-10"	45'-11"	G	40.24	25.2	55.12	-19.09	37.2	5.51	34.29	29.76	6836
65'-7"	60'-8"	H	50.08	25.2	55.12	-19.09	37.2	7.17	34.29	29.76	7056
86'-11"	82'-0"	J	63.86	23.62	55.12	-31.65	35.63	9.45	34.29	29.76	7938
104'-12"	100'-1"	K	75.67	23.62	55.12	-31.65	35.63	11.36	34.29	29.76	8600

\*HOL with drum brake

\*\*Presence of a drum brake increases weight by 176 lbs.

Motor dimensions

Motor	P6
MOT (inch)	21.1
Weight ( lb)	190

Traveling dimensions

Motor	MF06LA
TMO (inch)	18.86
Weight ( lb)	17

Trolley dimensions

B min	B max	C	ØWD	ØBU	BU	BUH	E1	E2	E3	GEA	M3
4.72	24.02	74.06	7.09	3.15	14.37	2.09	24.67	27.44	10.59	8.58	1.73
TD	TF	TH	TW								
39.69	1.75	8.19	2.09								

D007604\_A  
252560

Note: Weight calculated with P6 and MF06LA motors when B=11.8 inch.

Note: All dimensions in inch.