

Normal Headroom Hoist EXSX6, REEVING: 061; Class I, Division 2

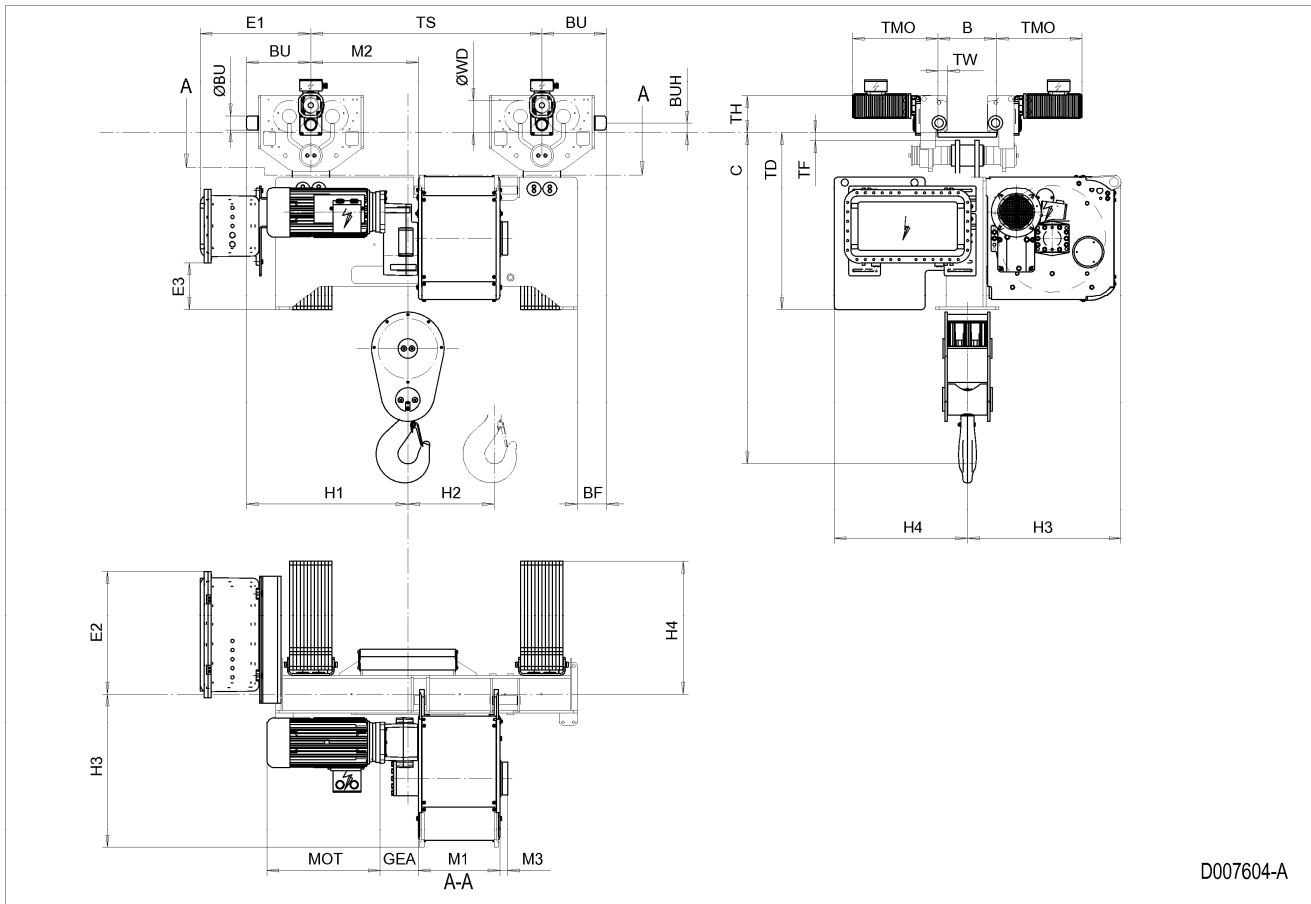

D007604-A

HOL m	HOL* m	Length code	M1 mm	M2 mm	TS mm	BF mm	H1 mm	H2 mm	H3 mm	H4 mm	Weight** kg
5	3.5	C	462	610	1310	165	915	46	871	756	2600
7	5.5	D	562	610	1310	165	915	63	871	756	2700
9	7.5	E	682	560	1060	-315	865	84	871	756	2800
12	10.5	F	832	560	1060	-315	865	107	871	756	2900
15.5	14	G	1022	640	1400	-485	945	140	871	756	3100
20	18.5	H	1272	640	1400	-485	945	182	871	756	3200
26.5	25	J	1622	600	1400	-804	905	240	871	756	3600
32	30.5	K	1922	600	1400	-804	905	289	871	756	3900

*HOL with drum brake

**Presence of a drum brake increases weight by 80 kgs.

Motor dimensions

Motor	P6
MOT (mm)	536
Weight (kg)	86

Traveling dimensions

Motor	MF06LA
TMO (mm)	479
Weight (kg)	7.8

Trolley dimensions

B min	B max	C	ØWD	ØBU	BU	BUH	E1	E2	E3	GEA	M3
120	610	1881	180	80	365	53	626.6	697	269.1	218	44
TD	TF	TH	TW								
1008	44.5	208	53								

D007604_A

252560

Note: Weight calculated with P6 and MF06LA motors when B=300 mm.

Note: All dimensions in mm.